

REV.	ECN NO.	CONTENT	DATE	ENGINEER
AO				

性能	
额定规格	DC12V/50mA
接触电阻	≤100mΩ
绝缘电阻	≥100MΩ
耐电压	AC250V/min
动作力	160/260±50gf

A	H (高度)
∅3.0	2.5
∅3.0	2.7
∅3.0	3.1
∅3.0	3.4
∅2.9	3.7
∅2.9	4.3
∅2.9	5
∅2.9	5.5

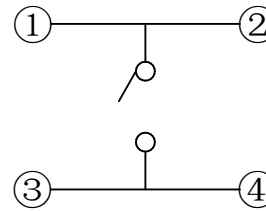
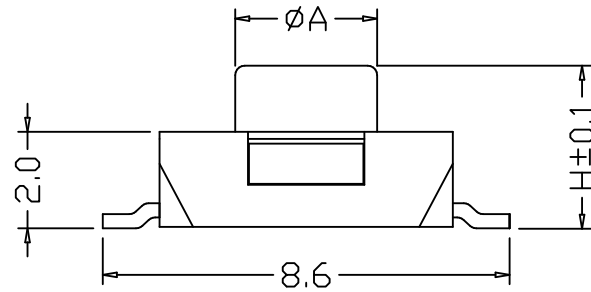

电路图

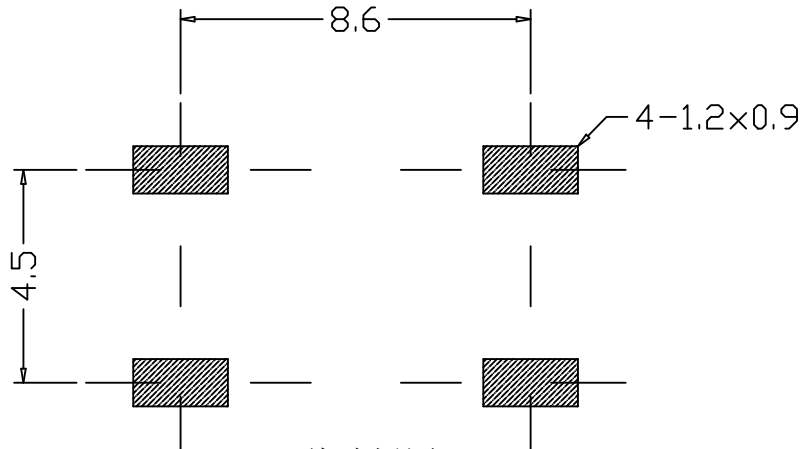

PCB线路板图

序号	产品名称	材料规格	表面处理 颜色	数量
1	按钮	PPA		1
2	盖板	不锈钢304	镀铜锡	1
3	簧片	不锈钢		1
4	底座	PPA		1
5	接线片	铜	镀银	1

THIS DOCUMENT IS THE SOLE PROPERTY OF BBJconn Technology Co.,Ltd. Corporation AND SHOULD NOT BE USED IN WHOLE OR IN PART WITHOUT PRIOR WRITTEN PERMISSION. PDWG:NO: 0472-1

深圳市步步精科技有限公司

.X: ±0.38 .XX: ±0.25 .XXX: ±0.13	X': ±3" .X': ±2" .XX': ±1"	NAME: Cá ʹġ ʹġ 6.2x6.2x2.5 Ē½xù ĒĀ½ĀĬĒĒ- ʹʹĐă, ŌĬĒĒ- 160GF ʹġ± ʹʹĐă, ŌĬĒĒ
APPD. JM_Zheng	CHKD. TSP	DR. LYX
PJ. NO.: TS.18.07-12-3Z-01		SIZE: A4 DRW NO.:
FINISH: SEE NOTES		MAT'L.: SEE NOTES
SCALE: N/A	REV.: AO	UNIT: mm
PAGE: 1/1		

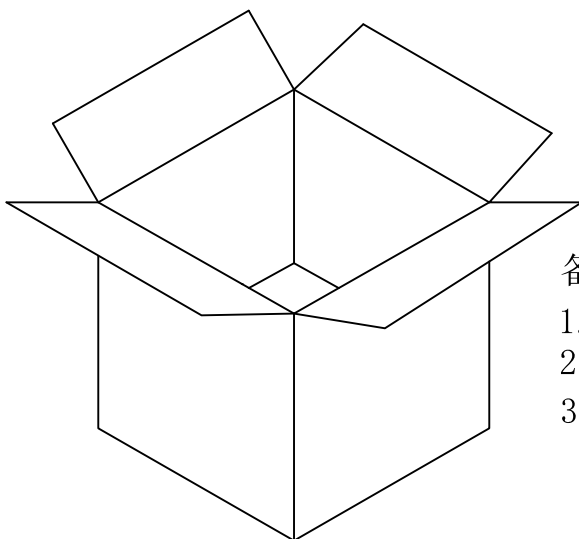
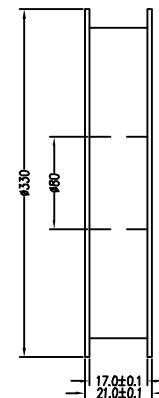
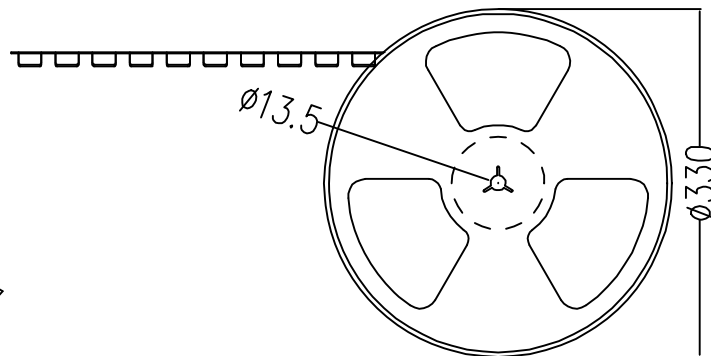
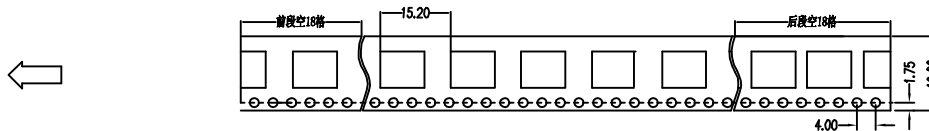
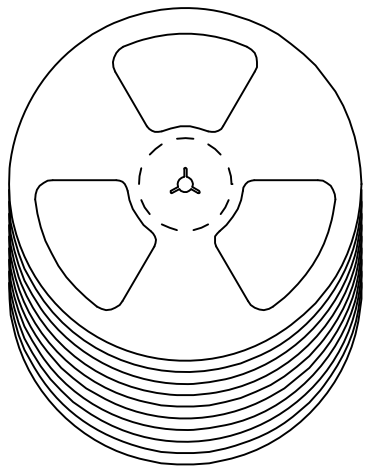

备注:

1. 包装数量: 1000/PCS
2. 包装袋长度: 每卷前后各空10-20个空格, 中间包装。
3. 材质:
载体: 聚丙烯 (PS), 阻抗 $10^{6-9} \Omega$
上带: 聚乙烯 (PET), 阻抗 $10^{6-11} \Omega$
卷盘: 聚苯乙烯。

纸箱规格: 345*345*23MM

纸箱规格: 345*345*35MM

THIS DOCUMENT IS THE SOLE PROPERTY OF BBJconn Technology Co.,Ltd Corporation AND SHOULD NOT BE USED IN WHOLE OR IN PART WITHOUT PRIOR WRITTEN PERMISSION.		深圳市步步精科技有限公司	
.X: ±0.38 .XX: ±0.25 .XXX: ±0.13		NAME: 轻触开关 6.2x6.2x2.5 平座 四脚贴片 不锈钢弹片 160GF 红柄 不锈钢盖	
APPD. JM_Zheng	P.J. NO.: TS.18.07-12-3Z-01		SIZE: A4
CHKD. TSP	FINISH: SEE NOTES		MAT'L.: SEE NOTES
DR. LYX	SCALE: N/A	REV.: A0	UNIT: mm
PDWG.NO: 0472-1	PAGE: 1/1		