

REV.	ECN NO	CONTENT	DATE	ENGINEER
A0		Initial release	/	SGF

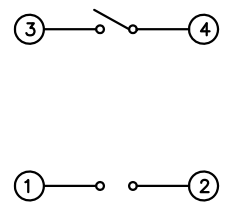

项目	标准
电气性能	额定电流: 0.1A
	额定电压: 12V DC
	接触电阻: 200mΩ max.
	绝缘电阻: 100MΩ min.100V DC
机械性能	耐压强度: 100V AC (50/60Hz foy 1 minute)
	操作力度: 50 ± 30gf
	工作寿命: 50,000 cycles
环境性能	总行程: 0.45mm-2.0mm
	接触行程: 0.45 ± 0.15mm
环境性能	温度范围: -10°C ~ +60°C.

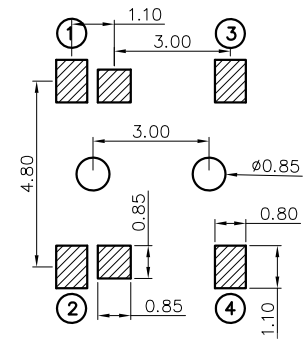
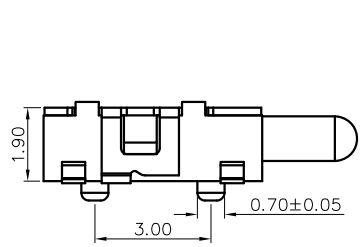
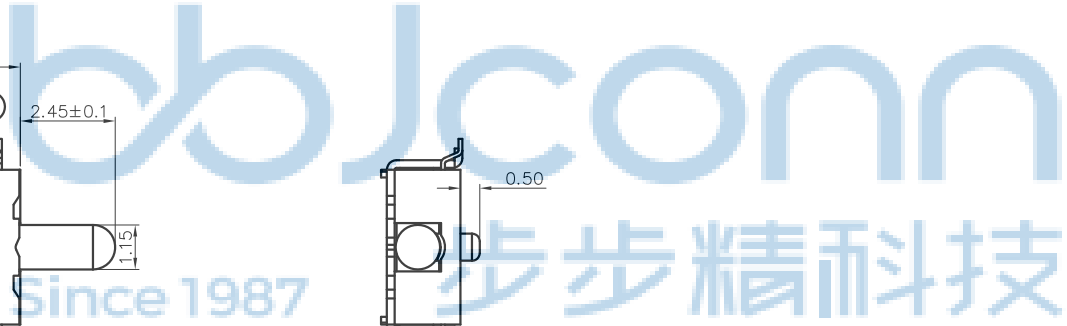
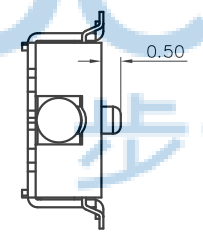
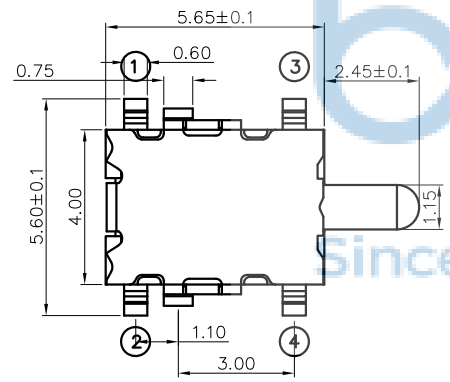

NO.	零件名称 Part Name	QTY	材料 Material	镀涂 Plating coating	颜色 colour	备注 Remarks
E	弹 簧	1	SUS 304 外φ1.2X6.4	/	银白色	
D	嵌 片	1	Qsn6.5-01 T=0.2	镀银	银白色镶银	
C	盖 子	1	H62 Y T=0.2	镀银	银白色	
B	底 座	1	LCP	/	黑 色	
A	按 钮	1	LCP	/	黑 色	

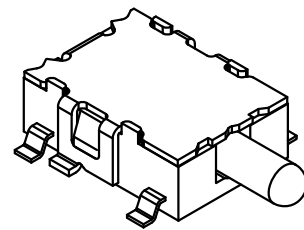
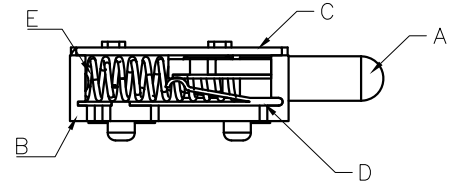

THIS DOCUMENT IS THE SOLE PROPERTY OF BBJconn Technology Co.,Ltd. Corporation AND SHOULD NOT BE USED IN WHOLE OR IN PART WITHOUT PRIOR WRITTEN PERMISSION.

PDWG.NO: 0124-1

DR. SGF

APPD. JM_Zheng

CHKD. LYX

NAME: 轻触开关 长头大乌龟带柱 L=5.65 贴片 不锈钢弹片 50G

PJ. NO.: TS.33.73-19-3A-01

SIZE: A4 DRW NO.:

FINISH: SEE NOTES MAT'L.: SEE NOTES

SCALE: N/A REV.: A0 UNIT: mm PAGE: 1/2

深圳市步步精科技有限公司

REV.	ECN NO	CONTENT	DATE	ENGINEER
A0		Initial release	/	SGF

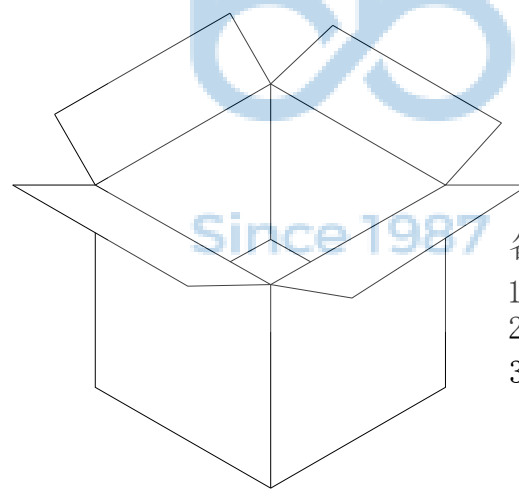
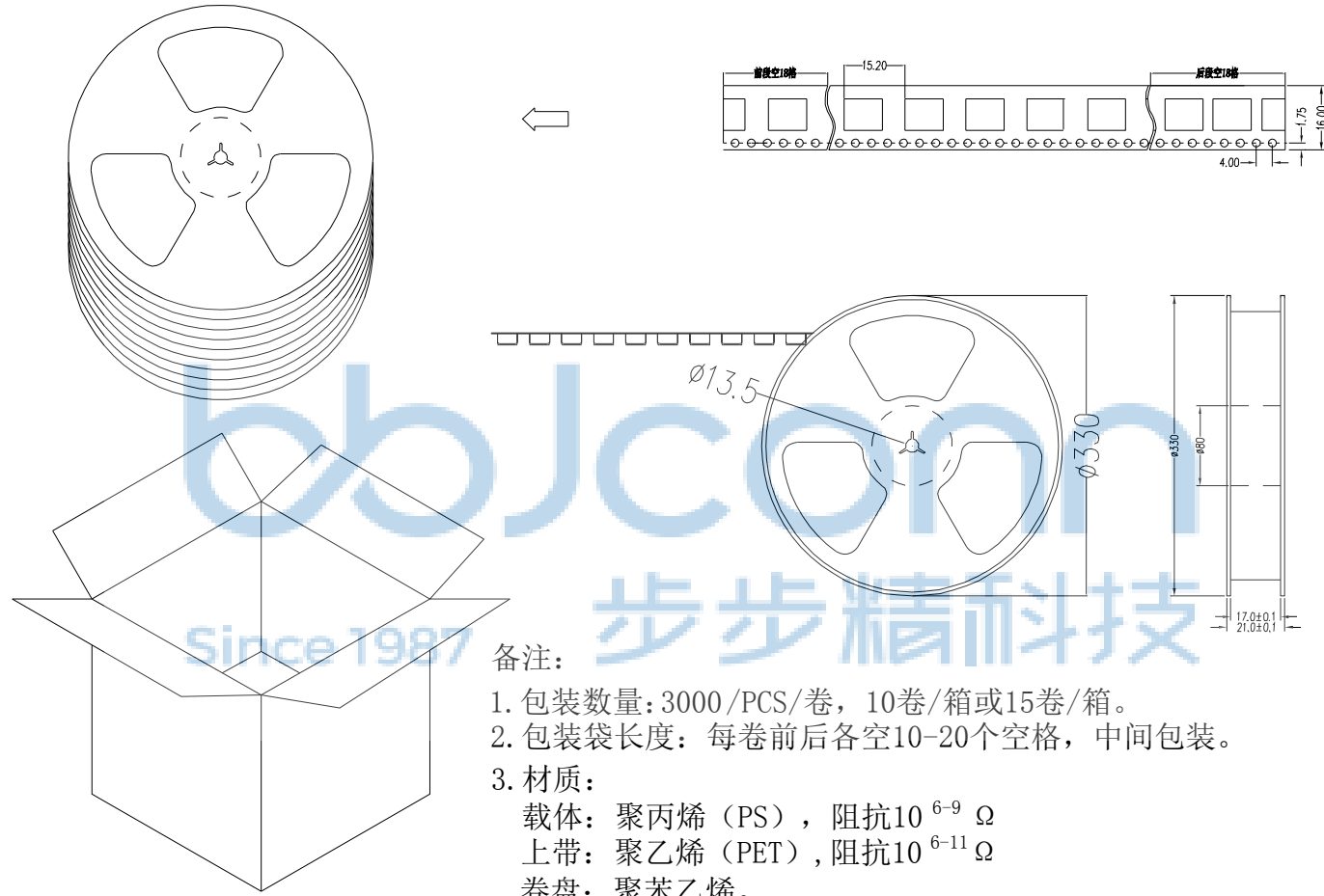

备注:

1. 包装数量: 3000/PCS/卷, 10卷/箱或15卷/箱。
2. 包装袋长度: 每卷前后各空10-20个空格, 中间包装。
3. 材质:
载体: 聚丙烯 (PS), 阻抗 $10^{6-9} \Omega$
上带: 聚乙烯 (PET), 阻抗 $10^{6-11} \Omega$
卷盘: 聚苯乙烯。

纸箱规格: 345*345*23MM
纸箱规格: 345*345*35MM



THIS DOCUMENT IS THE SOLE PROPERTY OF BBJconn Technology Co.,Ltd. Corporation AND SHOULD NOT BE USED IN WHOLE OR IN PART WITHOUT PRIOR WRITTEN PERMISSION.		深圳市步步精科技有限公司 .X: ±0.38 .X': ±3' .XX: ±0.25 .X'': ±2' .XXX: ±0.13 .X''': ±1'		NAME: 轻触开关 长头大乌龟带柱 L=5.65 贴片 不锈钢弹片 50G	
APPD.	JM_Zheng	PJ. NO.: TS.33.73-19-3A-01 SIZE: A4 DRW NO.:		FINISH: SEE NOTES MAT'L.: SEE NOTES	
CHKD.	LYX	SCALE: N/A		REV.: A0	UNIT: mm
PDWG.NO:	0124-1	DR.	SGF	PAGE: 2/2	