

REV.	DESCRIPTION	NAME	DATE
A	NEWS ISSUE		
B	基座的长x宽由6.15x6.15改为6.0x6.0	TSP	2023/2/3

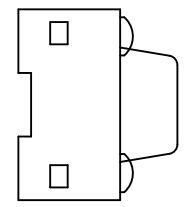

主要技术参数		
1	操作行程	0.25±0.1mm
2	额定电压、电流	DC12V/50mA
3	接触电阻	30mΩ(max)
4	绝缘电阻	100MΩ(mi n)
5	耐 压	250V AC/1mi n
6	动 作 力	160/260 ± 30gf
7	使用寿命	80000次
8	尺 寸	未注公差均按 GB/T1804-2000

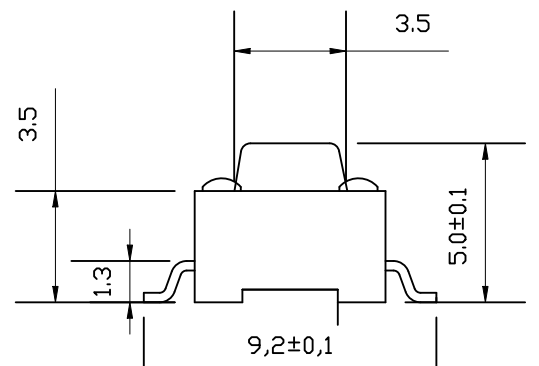
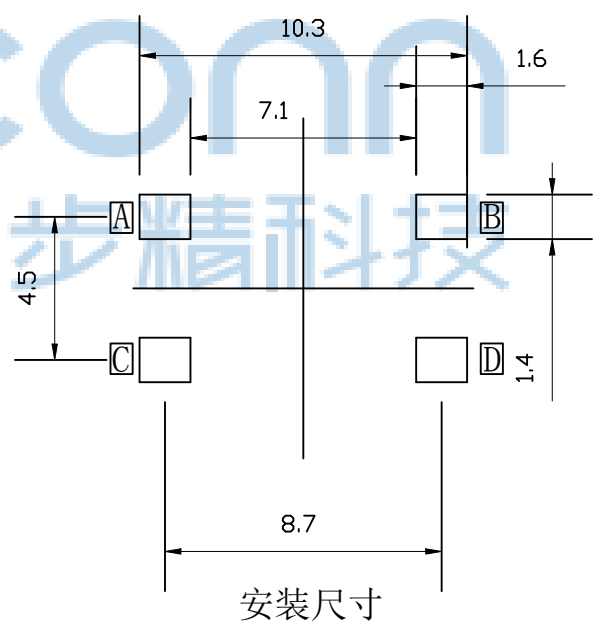
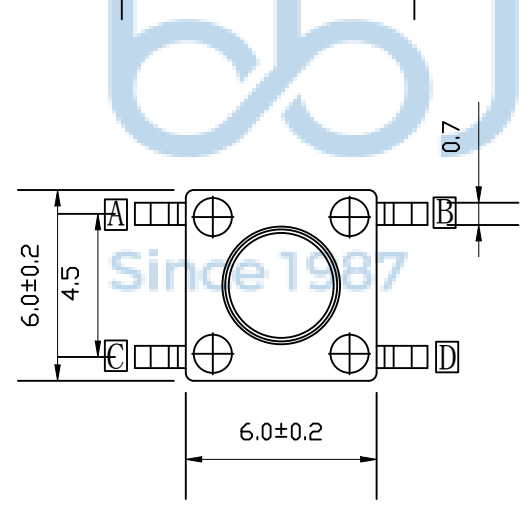

序号	名称	数量	材料	镀涂/颜色
4	弹片	1	不锈钢 SUS304	镀银/白色
3	按子	1	PPA	黑色
2	盖板	1	铁 SPCC	镀银/白色
1	底座	1	黄铜与PPA (H65)	黑色与镀银

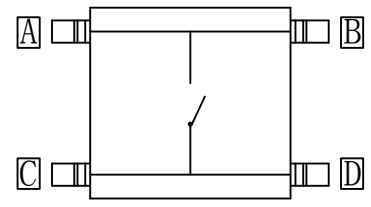

电器原理图



THIS DOCUMENT IS THE SOLE PROPERTY OF BBJconn Technology Co.,Ltd. Corporation AND SHOULD NOT BE USED IN WHOLE OR IN PART WITHOUT PRIOR WRITTEN PERMISSION.

PDWG.NO: 0013-1

APPD. JM_Zheng
CHKD. LYX
DR. LHC

深圳市步步精科技有限公司

NAME: 轻触开关 6x6x5.0 贴片 不锈钢弹片 160G 9.2脚

PJ. NO.: TS.01.13-12-31-02
SIZE: A4 DRW NO.:
FINISH: SEE NOTES MAT'L.: SEE NOTES
SCALE: N/A REV.: A3 UNIT: mm PAGE: 1/1

REV.	ECN NO	CONTENT	DATE	ENGINEER
A0				

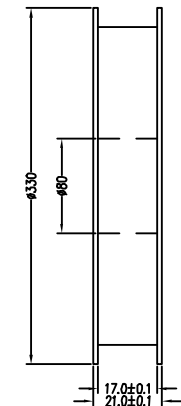
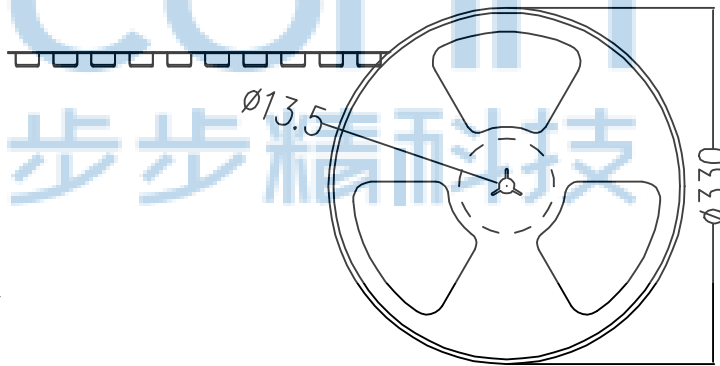
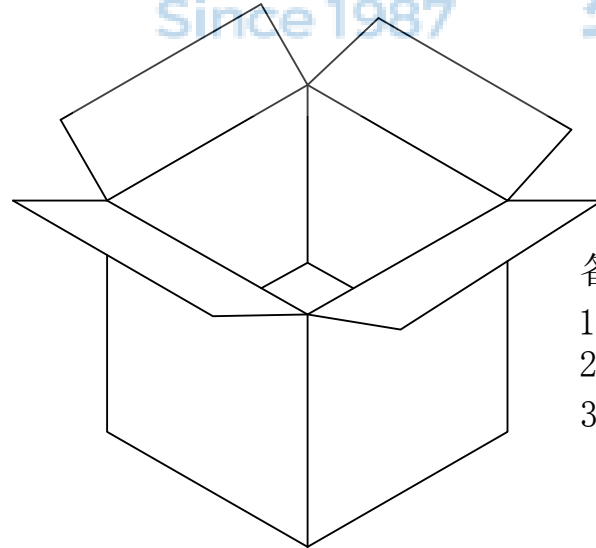
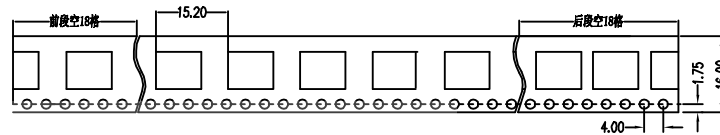
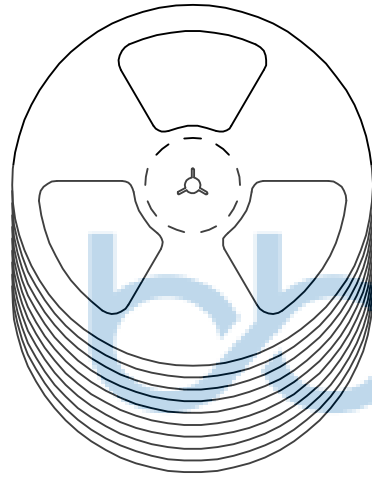

1000/PCS卷

备注:

1. 包装数量: 1000/PCS/卷, 10卷/箱或15卷/箱。
2. 包装袋长度: 每卷前后各空10-20个空格, 中间包装。
3. 材质:
 载体: 聚丙烯 (PS), 阻抗 $10^{6-9} \Omega$
 上带: 聚乙烯 (PET), 阻抗 $10^{6-11} \Omega$
 卷盘: 聚苯乙烯。

纸箱规格: 345*345*23MM
 纸箱规格: 345*345*35MM

THIS DOCUMENT IS THE SOLE PROPERTY OF BBJconn Technology Co.,Ltd. Corporation AND SHOULD NOT BE USED IN WHOLE OR IN PART WITHOUT PRIOR WRITTEN PERMISSION.		PDWG.NO: 0013-1		深圳市步步精科技有限公司 .X: ±0.38 .XX: ±0.25 .XXX: ±0.13 X': ±3' X'': ±2' XX': ±1'		NAME: 轻触开关 6x6x5.0 贴片 不锈钢弹片 160G 9.2脚 APPD. JM_Zheng CHKD. LYX DR. LHC		PJ. NO.: TS.01.13-12-31-02 SIZE: A4 DRW NO.: FINISH: SEE NOTES MAT'L.: SEE NOTES SCALE: N/A REV.: A3 UNIT: mm PAGE: 1/1	
--	--	-----------------	--	---	--	---	--	--	--