

REV.	ECN NO	CONTENT	DATE	ENGINEER
A0		Initial release	/	SGF

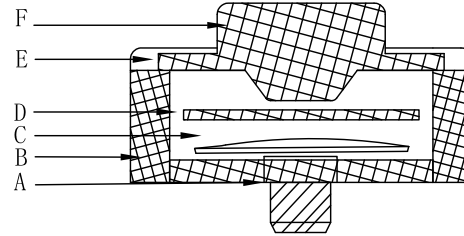

技术参数

1. 额定电流: 50mA 12V DC
2. 接触电阻: 100毫欧
3. 行程: 0.15 ± 0.05mm
4. 绝缘电阻: 100兆欧
5. 抗电强度: 100v 50Hz 1Min
6. 按 力: 160 ± 50gf
7. 寿 命: 10万次

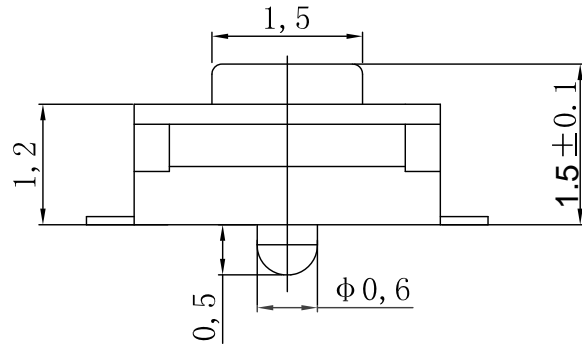
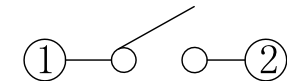
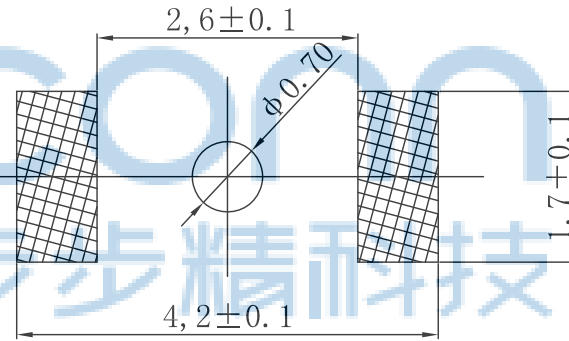
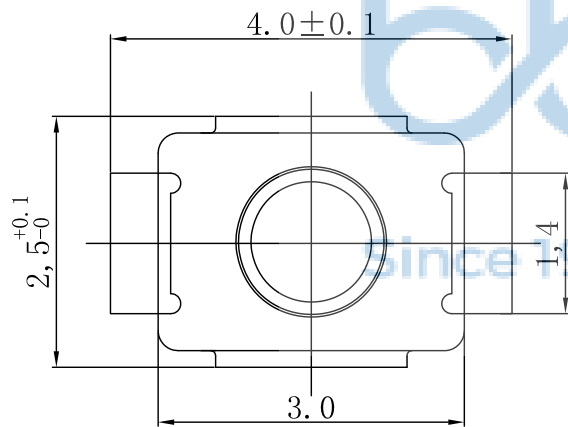

电器原理图

P C B 参考图



序号	名称	材 料	数量	备 注
F	盖板	黄铜	1	镀银
E	按钮	LCP	1	
D	防尘膜	聚酰亚胺	1	
C	簧片	不锈钢覆银	2	
B	基座	LCP	1	清洗
A	卡件	磷铜	1	镀银

THIS DOCUMENT IS THE SOLE PROPERTY OF BBJconn Technology Co., Ltd. Corporation AND SHOULD NOT BE USED IN WHOLE OR IN PART WITHOUT PRIOR WRITTEN PERMISSION.		深圳市步步精科技有限公司 .X: ±0.38 .X': ±3' .XX: ±0.25 .X'': ±2' .XXX: ±0.13 .X''': ±1'	
APPD.	JM_Zheng	NAME:	轻触开关 2.5x3x1.5 带柱俩脚小龟 不锈钢弹片 160gf
CHKD.	LYX	PJ. NO.:	TS.43.01-12-2Z-01
DR.	SGF	SIZE: A4	DRW NO.:
PDWG.NO: 0415-1		FINISH: SEE NOTES	MAT'L.: SEE NOTES
		SCALE: N/A	REV.: A0 UNIT: mm PAGE: 1/2

REV.	ECN NO	CONTENT	DATE	ENGINEER
A0		Initial release	/	SGF

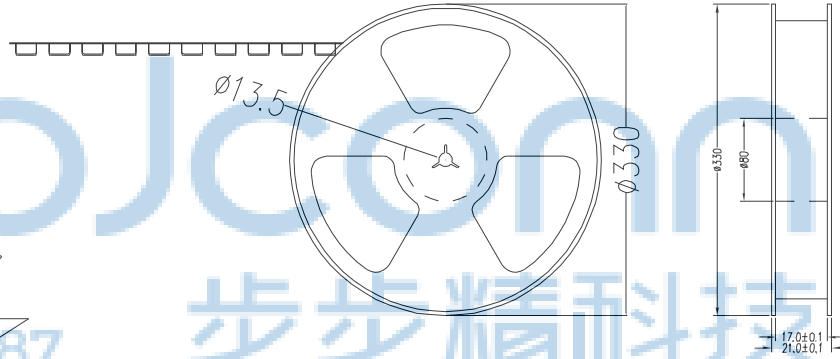
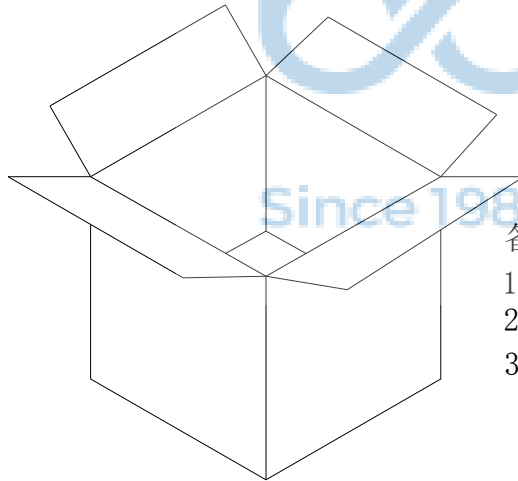
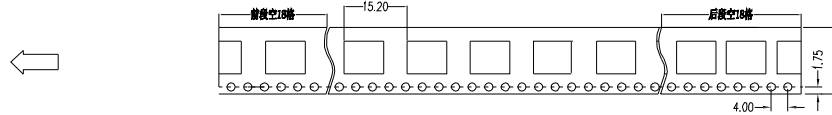
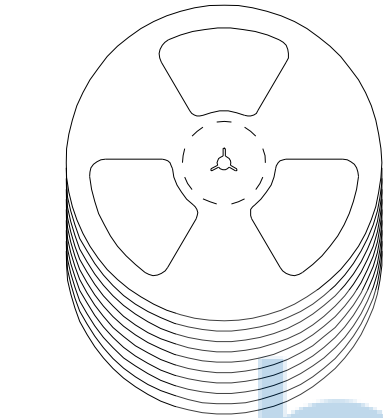

备注:

1. 包装数量: 3000 /PCS/卷, 10卷/箱或15卷/箱。
2. 包装袋长度: 每卷前后各空10-20个空格, 中间包装。
3. 材质:
载体: 聚丙烯 (PS), 阻抗 $10^{6-9} \Omega$
上带: 聚乙烯 (PET), 阻抗 $10^{6-11} \Omega$
卷盘: 聚苯乙烯。

纸箱规格: 345*345*23MM
纸箱规格: 345*345*35MM

THIS DOCUMENT IS THE SOLE PROPERTY OF BBJconn Technology Co.,Ltd. Corporation AND SHOULD NOT BE USED IN WHOLE OR IN PART WITHOUT PRIOR WRITTEN PERMISSION.		深圳市步步精科技有限公司	
PDWG.NO: 0415-1		DR. SGF	NAME: 轻触开关 2.5x3x1.5 带柱俩脚小龟 不锈钢弹片 160gf PJ. NO.: TS.43.01-12-2Z-01 SIZE: A4 DRW NO.: FINISH: SEE NOTES MAT'L.: SEE NOTES SCALE: N/A REV.: A0 UNIT: mm PAGE: 2/2
.X: ±0.38 .XX: ±0.25 .XXX: ±0.13	X': ±3" .X': ±2" .XX': ±1"	APPD. JM_Zheng	
CHKD. LYX			