

REV.	ECN NO	CONTENT	DATE	ENGINEER
A0		Initial release	/	TSP

Notes:

- Material:  
Housing: Lcp S475  
Terminal: C5191-H  
Shell: SUS304-H
- Plating:  
Terminal: 30u" Ni Underplated Overall  
G/F Plated On Contact Area  
Tin Plated On Solder Area  
Shell: 30u" Ni Underplated Overall  
G/F Plated On Solder Area
- Technical Speciality:  
Rated Voltage: 30V  
Current Rating: 0.5A  
Insulation Resistance: 1000MΩ Min.  
Contact Resistance: 100mΩ Max.  
Withstanding Voltage: 500V DC For 1 Minutes.  
Operating Temperature: -40°C ~ +85°C Humidity 80% R.H Max.

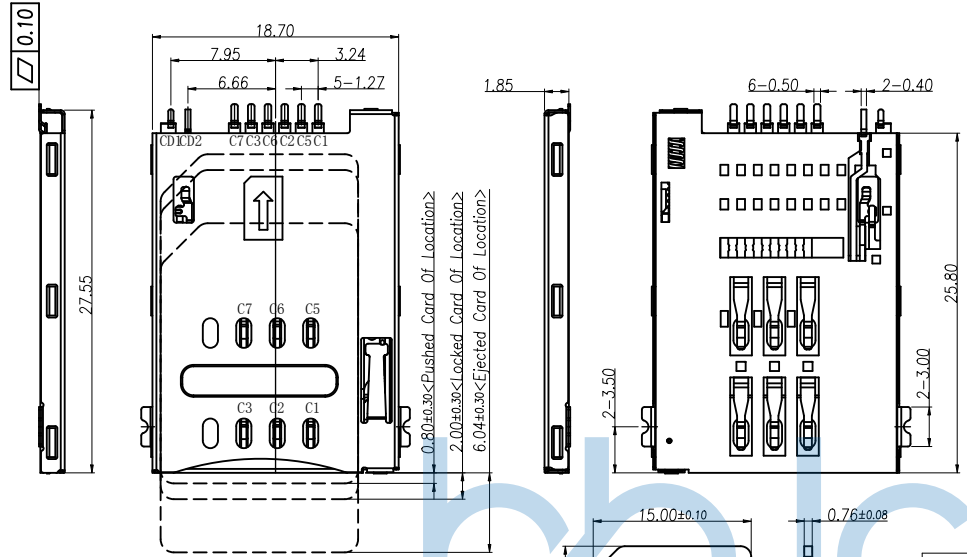

PIN/NO	ASSIGNMENT
C1	VCC
C2	RST
C3	CLK
C5	GND
C6	VPP
C7	I/O
CD1	DETECT SWITCH
CD2	DETECT SWITCH

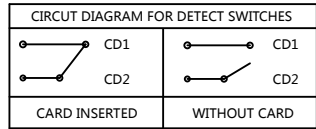
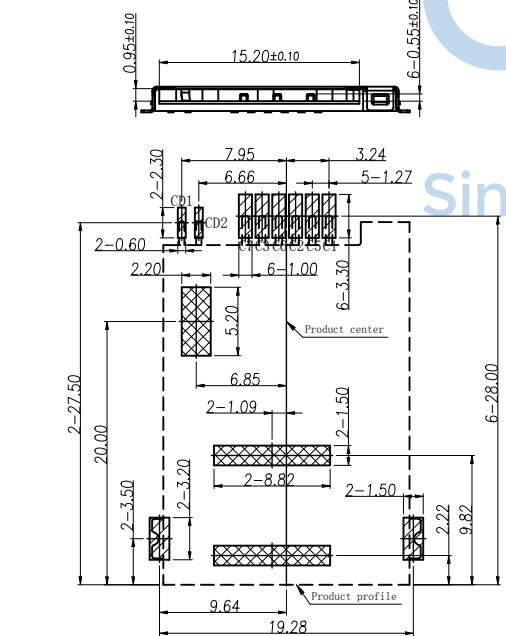

RECOMMENDED PCB LAYOUT

TOLERANCE: ±0.05

- SMT SOLDER AREA
- COPPER RESTRICTED AREA
- 1. TOUCH AREA OF CONTACT TIPS NO ELECTRICAL FUNCTION
- 2. NO FIRST PCB LAYOUT CIRCUITS IN THE AREA



THIS DOCUMENT IS THE SOLE PROPERTY OF BBJconn Technology Co., Ltd. CORPORATION AND SHOULD NOT BE USED IN WHOLE OR IN PART WITHOUT PRIOR WRITTEN PERMISSION.		深圳市步步精科技有限公司 .X: ±0.38    .X': ±3' .XX: ±0.25    .X'': ±2' .XXX: ±0.13    .X''': ±1'	
APPD.	JM_Zheng	NAME: 卡座 Push Push SIM CARD 6+2 6P 带CDPin H=1.85 贴片 无柱 编带	
CHKD.	LYX	PJ. NO.: 142-206-080001-S4G	
PDWG.NO:	0390-1	SIZE: A4 DRW NO.:	
DR.	TSP	FINISH: SEE NOTES    MAT'L.: SEE NOTES	
		SCALE: N/A	REV.: A0    UNIT: mm    PAGE: 1/2

REV.	ECN NO.	CONTENT	DATE	ENGINEER
A0		Initial release	/	TSP

**NOTES:**

- 1、Packing quantity per plate: 650PCS/Plate
- 2、Loading and packing method

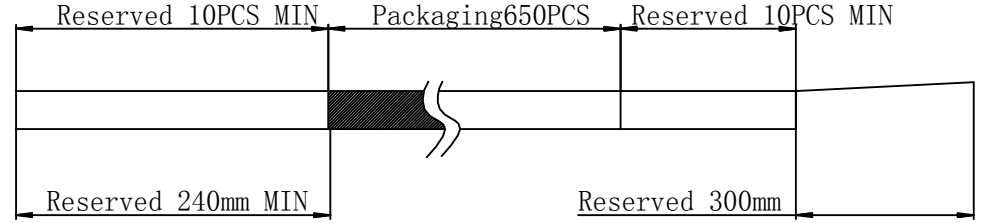

- 3、Total packaging: 3900PCS/Box

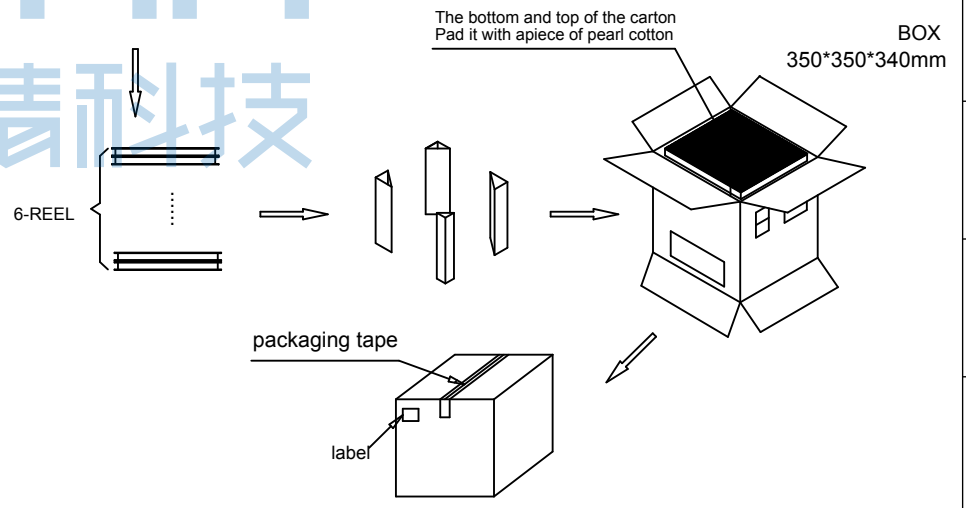
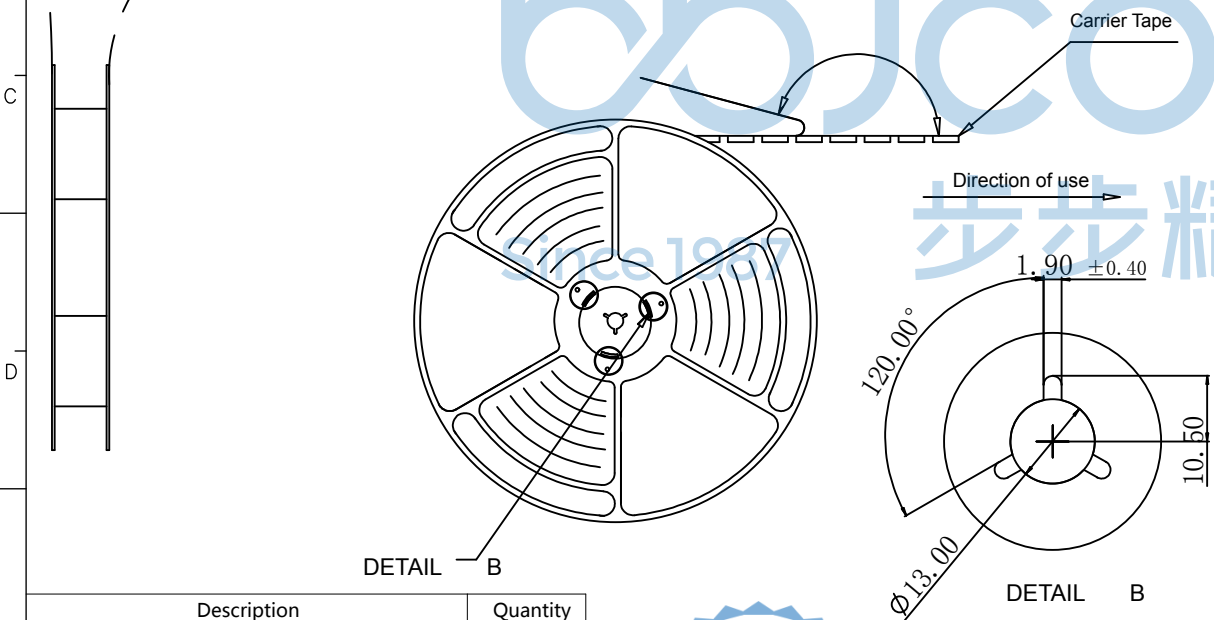
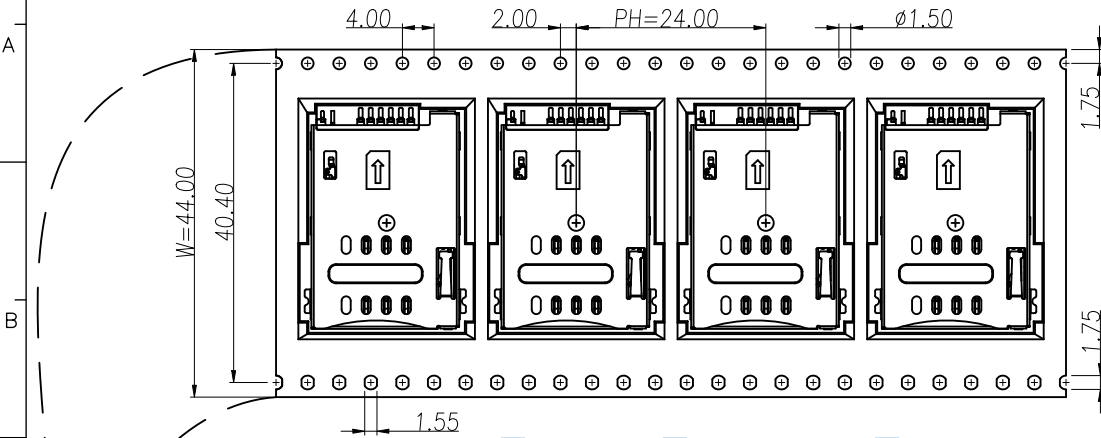

Description	Quantity
Carrier band (Black, PS W=44 PH=24,T=0.3)	96.48m
Box ( K=K,T=7.0,350*350*340 )	1PCS
PE Bag ( T=0.08mm , 730*760*730 )	1PCS
Self-adhesive ( W=37.50 )	97.80m
Beam ( K=K, T=7.0,95*95*290 )	4PCS
Pearl Wool ( 340*340*18 )	2PCS
REEL ( BLUE , 13Inches*24mm , φ330 )	6PCS
1.8H Push-Push SIM卡座	3900PCS



THIS DOCUMENT IS THE SOLE PROPERTY OF BBJconn Technology Co.,Ltd. CORPORATION AND SHOULD NOT BE USED IN WHOLE OR IN PART WITHOUT PRIOR WRITTEN PERMISSION.		深圳市步步精科技有限公司 .X: ±0.38 .X': ±3" .XX: ±0.25 .X": ±2" .XXX: ±0.13 .XX': ±1"	
APPD.	JM_Zheng	NAME: 卡座 Push Push SIM CARD 6+2 6P 带CDPin H=1.85 贴片 无柱 编带	
CHKD.	LYX	PJ. NO.: 142-206-080001-S4G	
DR.	TSP	SIZE: A4 DRW NO.:	
PDWG.NO:	0390-1	FINISH: SEE NOTES MAT'L.: SEE NOTES	
		SCALE: N/A	REV.: A0 UNIT: mm PAGE: 2/2