

REV.	ECN NO.	CONTENT	DATE	ENGINEER
A0				

1. 技术参数:

- 1.1 额定电流: 3.0A AC/DC
- 1.2 额定电压: 250V
- 1.3 耐电压: 1000V ACminute
- 1.4 接触电阻: 20mΩ MAX
- 1.5 绝缘电阻: 1000MΩ MIN
- 2. 工作温度: -25℃ ~ +85℃

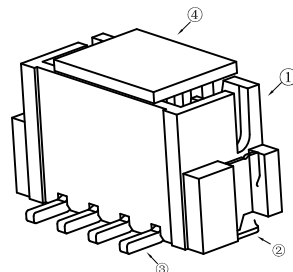
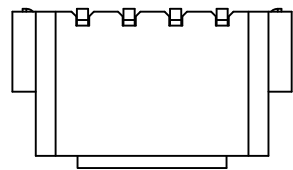
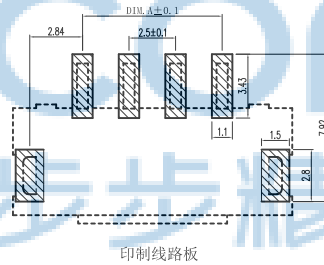
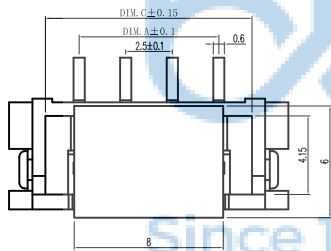
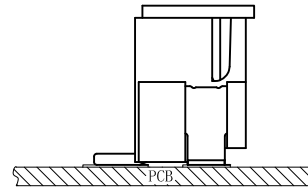
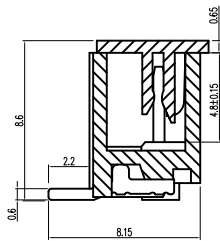
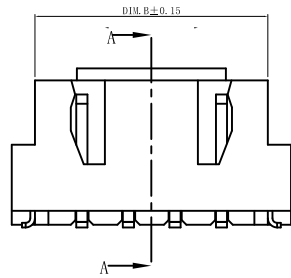

Circuits	Dimensions (mm)			Circuits	Dimensions (mm)		
	DIM. A	DIM. B	DIM. C		DIM. A	DIM. B	DIM. C
2.5LT-2P	2.5	7.50	6.0	2.5LT-12P	27.5	32.5	31.0
2.5LT-3P	5.0	10.0	8.5	2.5LT-13P	30.0	35.0	33.5
2.5LT-4P	7.5	12.5	11.0	2.5LT-14P	32.5	37.5	36.0
2.5LT-5P	10.0	15.0	13.5	2.5LT-15P	35.0	40.0	38.5
2.5LT-6P	12.5	17.5	16.0	2.5LT-16P	37.5	42.5	41.0
2.5LT-7P	15.0	20.0	18.5				
2.5LT-8P	17.5	22.5	21.0				
2.5LT-9P	20.0	25.0	23.5				
2.5LT-10P	22.5	27.5	26.0				
2.5LT-11P	25.0	30.0	28.5				

NO	物料名称	规格型号	数量(PCS)	材质	镀涂
①	基座	2.5	1	LCPE130i	本色
②	焊片	2.5	2	黄铜	锡
③	插针	2.5	2~20	黄铜	锡
④	盖板	2.5	1	LCPE130i	本色

THIS DOCUMENT IS THE SOLE PROPERTY OF BBJconn Technology Co., Ltd. CORPORATION AND SHOULD NOT BE USED IN WHOLE OR IN PART WITHOUT PRIOR WRITTEN PERMISSION.

PDWG.NO: 0013-1

DR. SGF

APPD. JM_Zheng

CHKD. LYX

NAME: 针座 2.54-9P 立贴 加盖 米黄色

PJ. NO.: WT.02.61-83-H002

SIZE: A4 | DRW NO.:

FINISH: SEE NOTES | MAT'L.: SEE NOTES

SCALE: N/A | REV.: A0 | UNIT: mm | PAGE: 1/2

深圳市步步精科技有限公司

REV.	ECN NO	CONTENT	DATE	ENGINEER
A0				

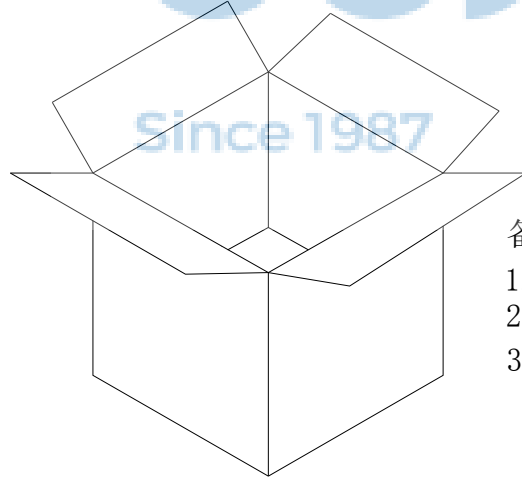
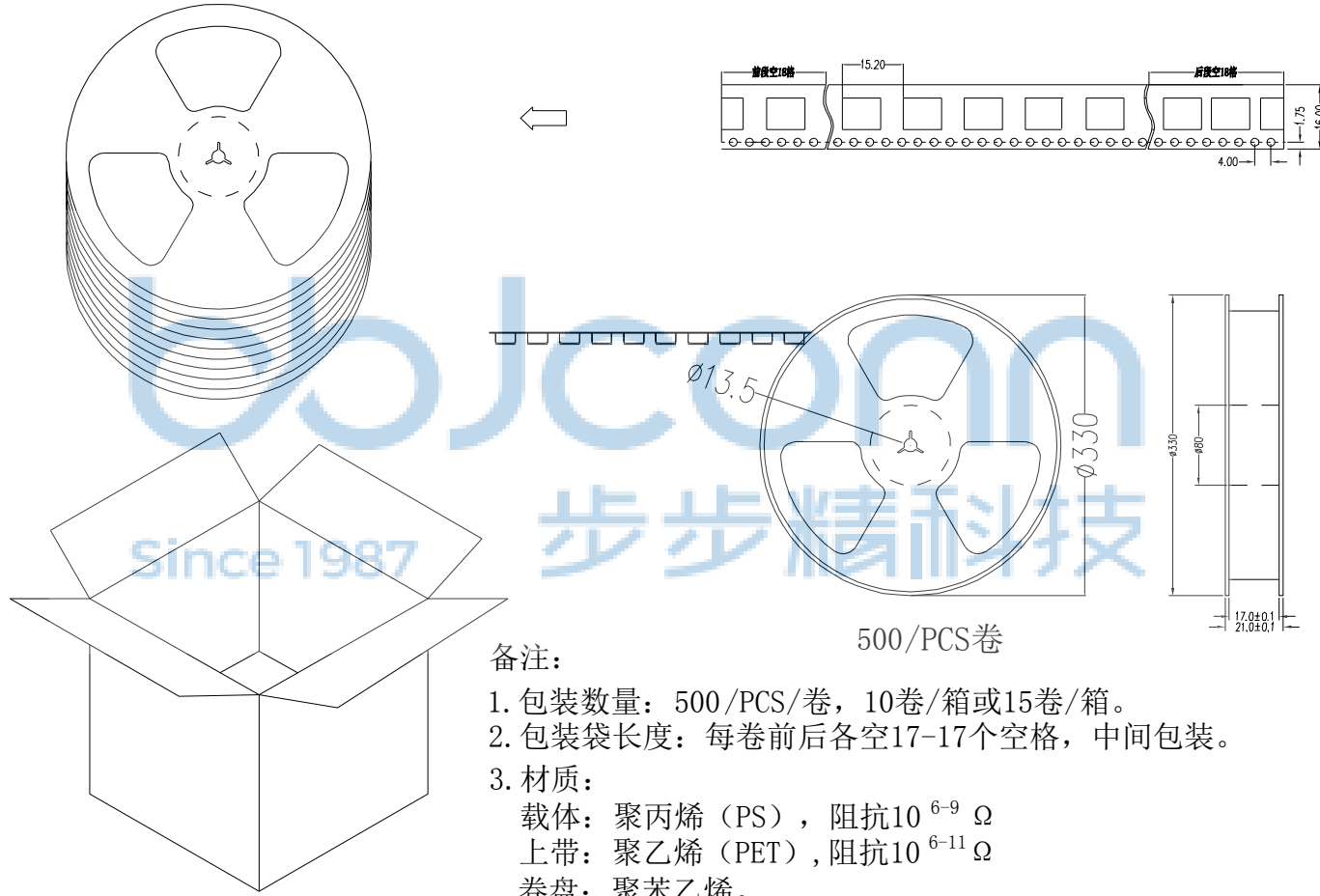

备注:

1. 包装数量: 500/PCS/卷, 10卷/箱或15卷/箱。
2. 包装袋长度: 每卷前后各空17-17个空格, 中间包装。
3. 材质:
载体: 聚丙烯 (PS), 阻抗 $10^{6-9} \Omega$
上带: 聚乙烯 (PET), 阻抗 $10^{6-11} \Omega$
卷盘: 聚苯乙烯。

纸箱规格: 345*345*23MM

纸箱规格: 345*345*35MM



THIS DOCUMENT IS THE SOLE PROPERTY OF BBJconn Technology Co.,Ltd. Corporation AND SHOULD NOT BE USED IN WHOLE OR IN PART WITHOUT PRIOR WRITTEN PERMISSION.		深圳市步步精科技有限公司 .X: ±0.38 .X': ±3' .XX: ±0.25 .X': ±2' .XXX: ±0.13 .XX': ±1'		NAME: 针座 2.54-9P 立贴 加盖 米黄色	
APPD.	JM_Zheng	PJ. NO.: WT.02.61-83-H002		SIZE: A4 DRW NO.:	
CHKD.	LYX	FINISH: SEE NOTES		MAT'L.: SEE NOTES	
PDWG.NO:	0013-1	DR.	SGF	SCALE: N/A	REV.: A0
				UNIT: mm	PAGE: 2/2