

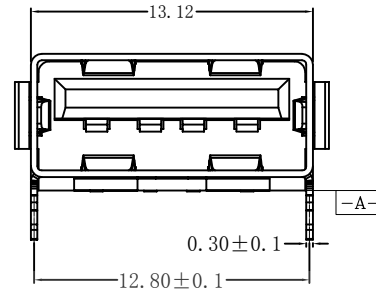

REV.	DESCRIPTION	NAME	DATE
A	NEWS ISSUE		

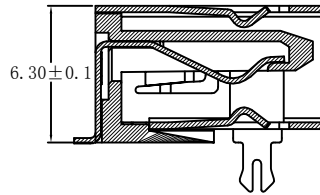
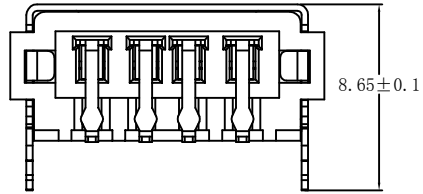

产品规格说明: (specifications)  
 电器特性: (Electrical characteristics)  
 1. 接触阻抗: (Contact Resistance)  
     最大值30毫欧: (30 milliohms MAX)  
 2. 耐电压: (Dielectric Withstanding Voitage:)  
     500 伏特交流电 (500V AC AT Sea Level)  
 3. 绝缘阻抗: (Insulation Resistance:)  
     最小值1000兆欧姆 (1000 mega-ohms MIN)

机械性能: (Mechanical:)  
 1. 插入力: (Insertion Force)  
     最大3.57kg (3.57kg MAX)  
 2. 拔出力: (Unmating Force:)  
     最少1.02kg (1.02 kg MIN)

材料: (Material):  
 1. 塑胶: (Housing): LCP黑色  
 2. 端子: (Contact): C2680  
 3. 外壳: (Shell): SPCC  
 电镀: (Finish):  
 1. 端子 (Contact): Au Plated ON Contact Area Over  
     50°80U Ni, Sn Plated On Solder Tails.  
     接触点镀金, 脚镀锡。

接触点镀金 0.8u'' 脚镀锡。  
 2. 外壳: (Shell): Nickel Plating 镀亮镍80u''  
 注明: 2. 所有物料均须符合RoHS标准。

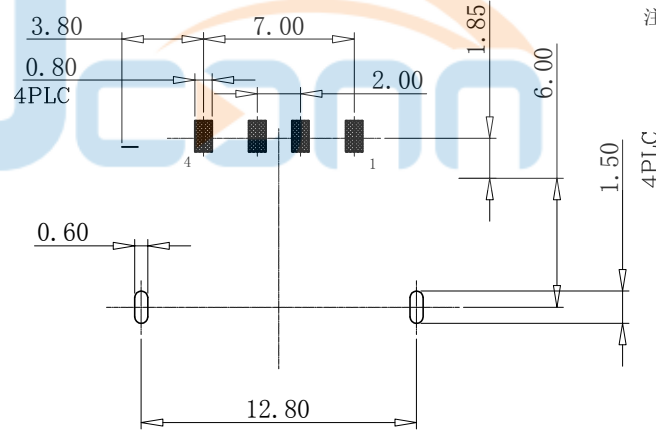
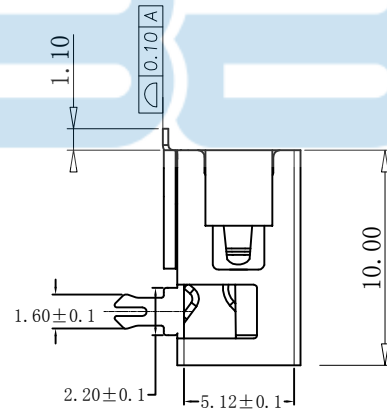
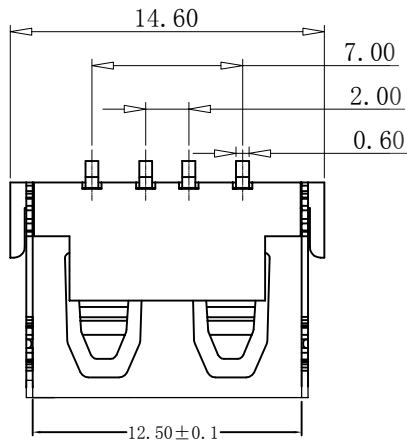

RECOMMENDED PCB LAYOUT  
 THICKNESS=1.0mm (TOLERANCES ±0.05)



TOLERANCE UNSPECIFIED X.X ±0.30 X.XX ±0.20 X.XXX ±0.10 X° ±5° X.X° ±2° CUSTOMER DRAWING		深圳市步步精科技有限公司 TITLE: USB 2.0 AF 90度 短体L=10.0 H=6.30 前插后贴 鱼叉脚 平口 LCP黑胶 铁壳			
DRAWN/ DATE	设计 ZY	SIZE:A4	UNIT:MM.	PART. NO:	UB. 01. 52-11-V001
CHECKED/ DATE	审核 LYX	SCALE: 1:1	PROJECTION	REV.: 版本	
APPROVED/ DATE	核准 LJP	DWG. PATH	0383-1		SHEET: 页码

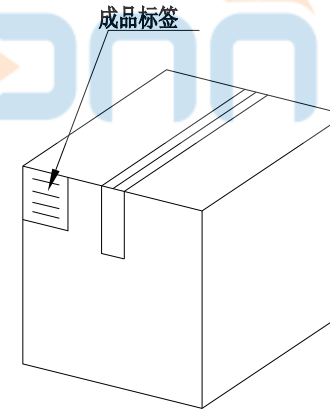
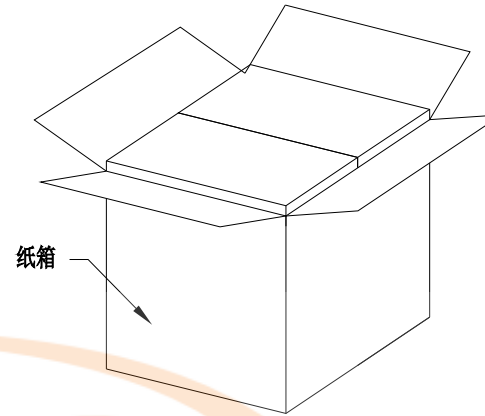
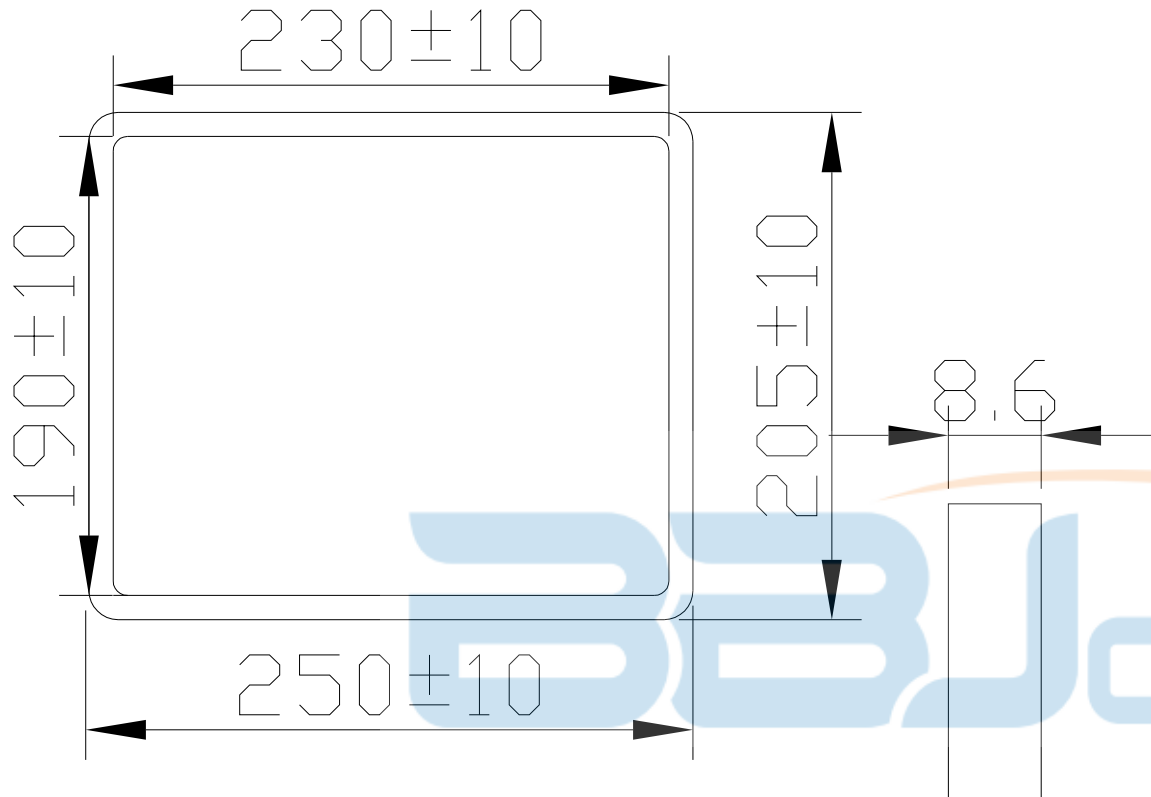

纸箱规格：350\*210\*290

### 1. 包装要求:

- 1.1 每盒吸塑盒包装100pcs;
- 1.2 每20盘放一箱，共计2000PCS;
- 1.3 纸箱外贴上标签



TOLERANCE UNSPECIFIED			深圳市步步精科技有限公司 TITLE: USB 2.0 AF 90度 短体L=10.0 H=6.30 前插后贴 鱼叉脚 平口 LCP黑胶 铁壳		
.0	±0.35				
.00	±0.25				
.000	±0.15				
X.°	±2.00°				
CUSTOMER DRAWING					
DRAWN/ DATE	设计 LYX	SIZE:A4	UNIT:MM.	PART. NO: UB.01.52-11-V001	
CHECKED/ DATE	审核 HMY	SCALE: 1:1	PROJECTION	REV.: 版本	
APPROVED/ DATE	核准 LJP	DWG. PATH	0383-1		SHEET: 页码