

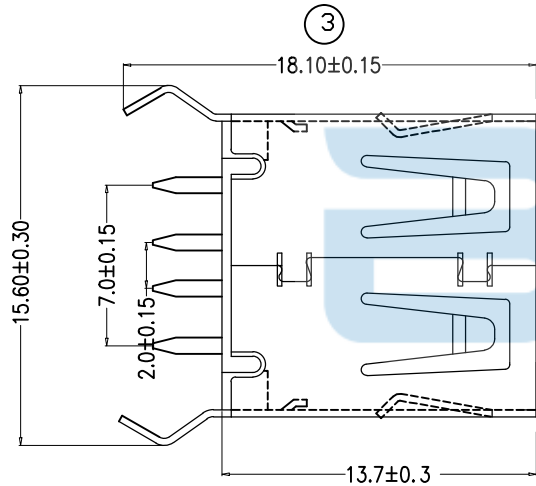

REV.	DESCRIPTION	NAME	DATE
A	NEWS ISSUE		

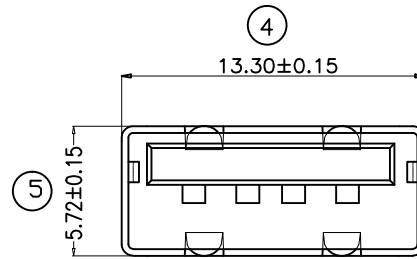
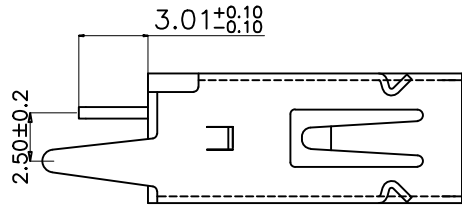

①

③

④

⑤

②

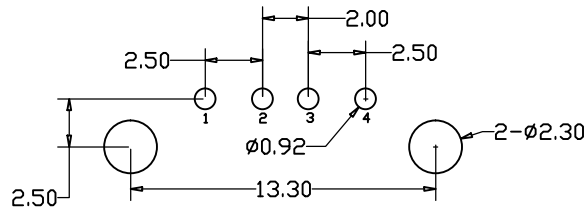

Recommended P. C. B Layout ( $\pm 0.05$ )

备注:

1. 材质:  
1-1 塑胶: LCP UL94V-0, 颜色: 白色/黑色  
1-2 端子: c2680  
1-3 外壳: C2680 /SPCC
2. 电镀:  
端子接触区域: 镀金1u"min.  
端子锡脚: 镀亮锡50u"min.  
端子整个表面: 镀镍50u"min.  
铜壳: 打铜底80u"min, 再镀光亮可焊镍80u"min

3. 电气性能:

- 3-1 耐电压: 500V 交流电
- 3-2 接触电阻: 30 毫欧 最大
- 3-3 绝缘阻抗: 1000 兆欧最小

4. 机械性能

- 4-1 插入力: 3.5kgf MAX
- 4-2 拨出力: 1.02kgf MIN

5. 环境

温度范围: -55° C TO +85° C

6. 需符合VAST-M01-W22《环境管理物质管制标准》文件要求
7. 产品必须过盐雾24H
8. 符号为QIP管控尺寸.



TOLERANCE UNSPECIFIED	
X.XXX	±0.10
X.XX	±0.20
X.X	±0.30
Angle	± 2°

**深圳市步步精科技有限公司**

TITLE:  
USB 2.0 AF 180度 H=13.7 弯脚 平口 LCP黑胶 铁壳 (端子DIP)

DRAWN/ DATE	设计 HMY	SIZE:A4	UNIT:MM.	PART. NO: UB.01.12-11-V003	
CHECKED/ DATE	审核 LYX	SCALE: 1:1		PROJECTION	REV.: 版本
APPROVED/ DATE	核准 LJP	DWG. PATH	0383-1		SHEET: 页码

REV.	DESCRIPTION	NAME	DATE
A	NEWS ISSUE		

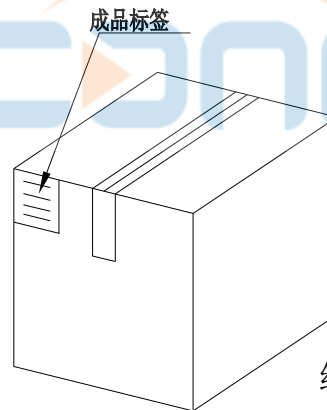
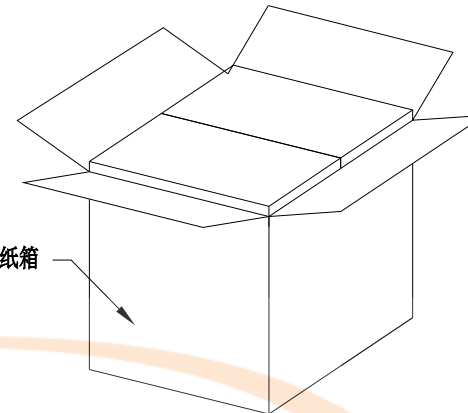
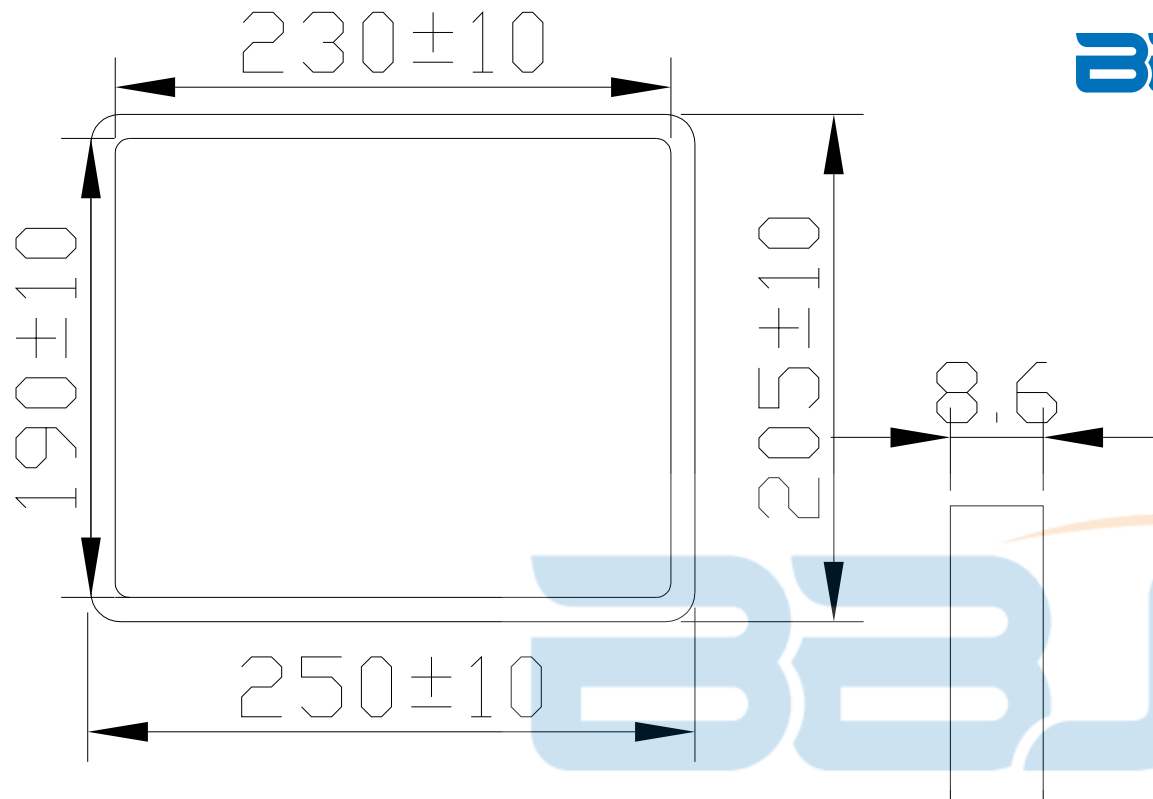

纸箱规格: 350\*210\*290

1. 包装要求:

- 1.1 每盒吸塑盒包装100pcs;
- 1.2 每20盘放一箱, 共计2000PCS;
- 1.3 纸箱外贴上标签



TOLERANCE UNSPECIFIED		深圳市步步精科技有限公司				
.0 ±0.35		TITLE:				
.00 ±0.25		USB 2.0 AF 180度 H=13.7 弯脚 平口 LCP黑胶 铁壳 (端子DIP)				
.000 ±0.15		DRAWN/ DATE	设计 HMY	SIZE: A4	UNIT: MM.	PART. NO: UB.01.12-11-V003
X.° ±2.00°		CHECKED/ DATE	审核 LYX	SCALE: 1:1	PROJECTION	REV.: 版本
CUSTOMER DRAWING		APPROVED/ DATE	核准 LJP	DWG. PATH	0383-1	SHEET: 页码