

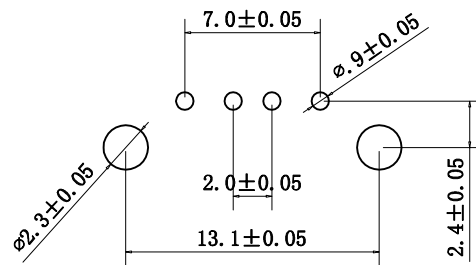

REV.	DESCRIPTION	NAME	DATE
A	NEWS ISSUE		

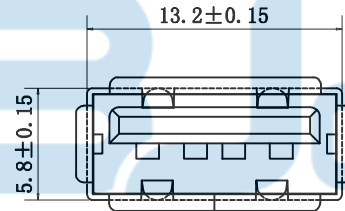

PCB LAYOUT

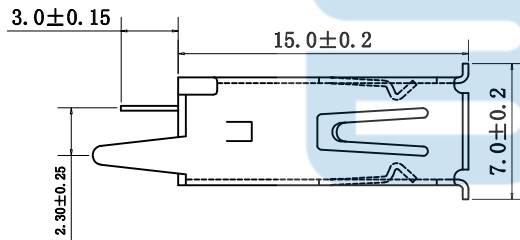
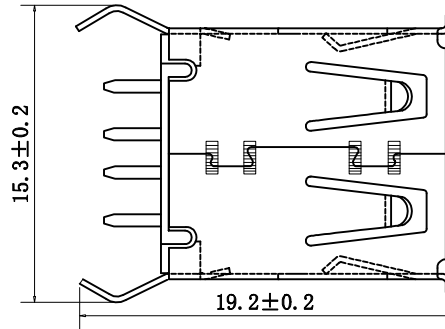
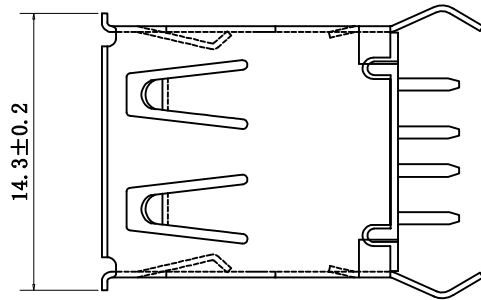

规格说明:Specifications:

电气特性:Electrical:

1. 额定电流: Current Rating
1.5A/contact terminal
2. 额定电压: Voltage Rating
30V DC
3. 接触阻抗: Contact Resistance
30 milliohms MAX
4. 耐电压: Dielectric Withstanding Voltage:
500 V AC AT Sea Level
5. 绝缘阻抗: Insulation Resistance:
1000MEGA ohms MIN

物理性能:Mechanical:

1. 插拔力: Connector Mate and Unmate Force
Mate force: 3.57kgf (MAX)
Unmate force: 1.02kgf (MIN)
2. 端子保持力: Terminal Retention

原材料:Material:

1. 塑胶: Housing:
PBT (30%F/G) LSOH
Hight Temperature Thermoplastics,
2. 外壳: Shell: SPCC/2680
Nickel Plating : 80u"
3. 端子: Contact: Copper Alloy c2680

电镀:Finish:

1. 端子: Contact: Plated Gold 1u" in Mating Area;
Tin On Solder Talls

TOLERANCE UNSPECIFIED

- . X ± 0.30
- . XX ± 0.20
- . XXX ± 0.10
- ANGLES ± 2.00°

BBJconn 深圳市步步精科技有限公司

TITLE:
USB 2.0 AF 180度 弯脚直插 H=15.0 DIP 卷边 PBT白胶 铁壳(脚距15.3 特殊款)

DRAWN/ DATE	设计 LJR	SIZE:A4	UNIT:MM	PART.NO:UB.01.11-21-V011	
CHECKED/ DATE	审核 LYX	SCALE: 1:1	PROJECTION		REV.: 版本
APPROVED/ DATE	核准 LJP	DWG. PATH	0383-1		SHEET: 页码

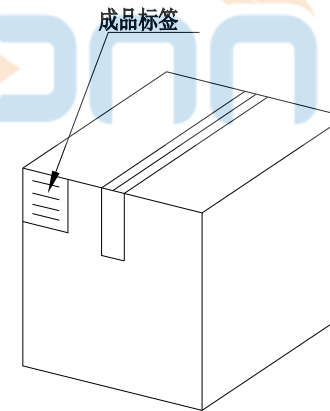
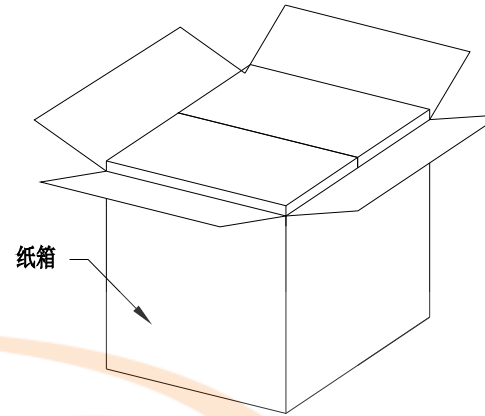
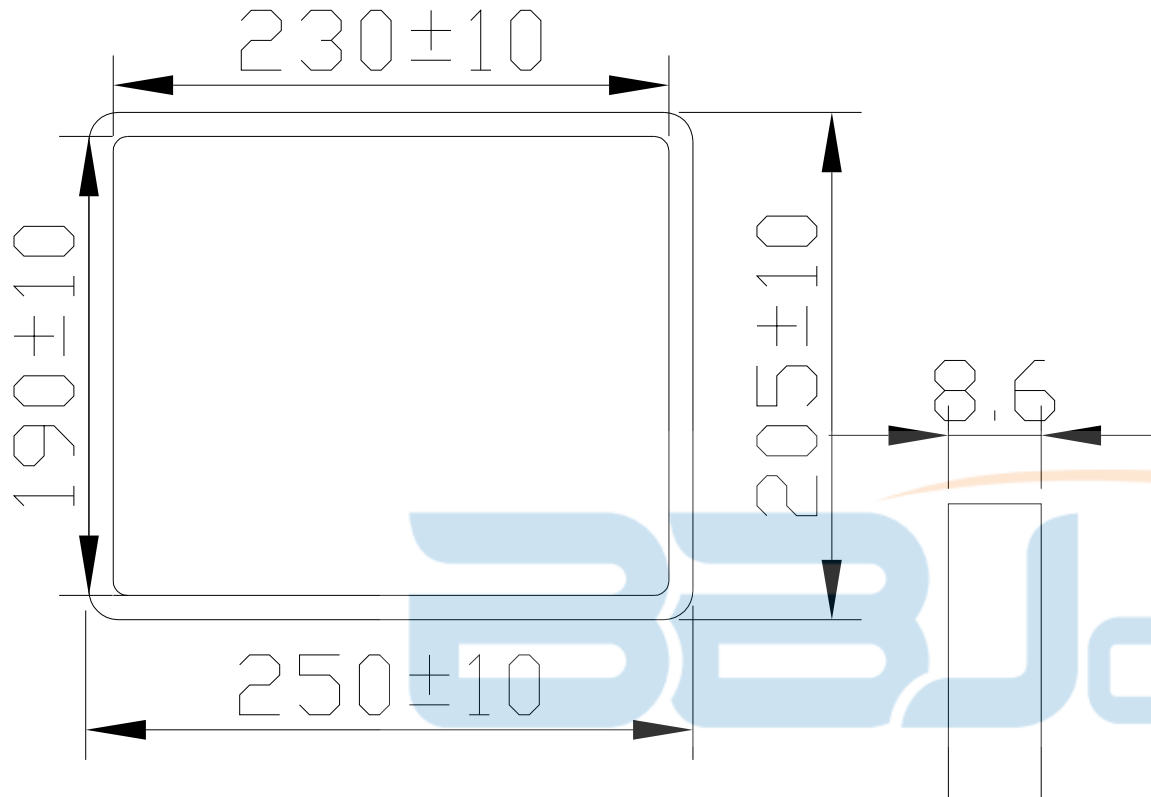

纸箱规格：350*210*290

1. 包装要求:

- 1.1 每盒吸塑盒包装100 pcs;
- 1.2 每20盘放一箱，共计2000PCS;
- 1.3 纸箱外贴上标签



TOLERANCE UNSPECIFIED		深圳市步步精科技有限公司 TITLE: USB 2.0 AF 180度 弯脚直插 H=15.0 DIP 卷边 PBT白胶 铁壳(脚距15.3 特殊款)								
.0	±0.35									
.00	±0.25	DRAWN/ DATE		设计	LJR	SIZE: A4	UNIT: MM.	PART. NO: UB.01.11-21-V011		
.000	±0.15	CHECKED/ DATE		审核	LYX	SCALE: 1:1		PROJECTION		REV.: 版本
X.°	±2.00°	APPROVED/ DATE		核准	LJP	DWG. PATH	0383-1		SHEET: 页码	
CUSTOMER DRAWING										