

REV.	DESCRIPTION	NAME	DATE
A	NEWS ISSUE		

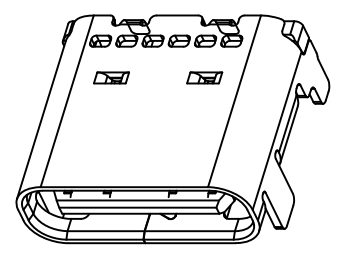

NOTE:

- MATERIAL SPECIFICATION:
  - HOUSING: HIGH TEMPERATURE RESISTANT PLASTIC, PA9T BLACK UL94 V-0.
  - CONTACTS: COPPER ALLOY C1815
  - EMI PLATE: STAINLESS STEEL
  - FRONT SHELL: STAINLESS STEEL
  - MID PLATE: STAINLESS STEEL
- PLATING SPECIFICATION:
  - CONTACTS:
    - Ni 50μ" MIN. UNDER PLATED OVER ALL.
    - Au PLATED ON THE FUNCTIONAL AREA OF CONTACT. (GOLD PLATING THICKNESS FOLLOW Au 1u )
  - FRONT SHELL:
    - Ni 30μ" MIN. UNDER PLATED OVER ALL.
  - MID PLATE:
    - Ni 30μ" MIN. UNDER PLATED OVER ALL.
    - Sn 80μ" MIN. PLATED OVER ALL.
  - EMI PLATE:
    - CLEAR ONLY
- MECHANICAL PERFORMANCE:
  - INSERTION FORCE: 0.5~2.0kgf.
  - REMOVAL FORCE: 0.8kgf~2.0kgf.
  - DURABILITY: 10000 CYCLES.
- ELECTRICAL PERFORMANCE:
  - CURRENT RATING: 5.0A  
VOLTAGE RATING: 5.0V
  - LLCR:
    - VBUS & GND PINS AND OTHER PINS: 40mΩ / PIN MAX.
    - LLCR MAX. CHANGE OF ALL PINS: 10mΩ.
  - INSULATION RESISTANCE: 100MΩ MIN
  - DIELECTRIC WITHSTAND VOLTAGE, AC 100V FOR 1 MINUTE.
- ENVIRONMENTAL PERFORMANCE:
  - OPERATING TEMPERATURE: -25° C~+85° C.
  - IR REFLOW:
    - THE PEAK TEMPERATURE ON THE BOARD SHALL BE MAINTAINED FOR 10 SECONDS AT 260° C.

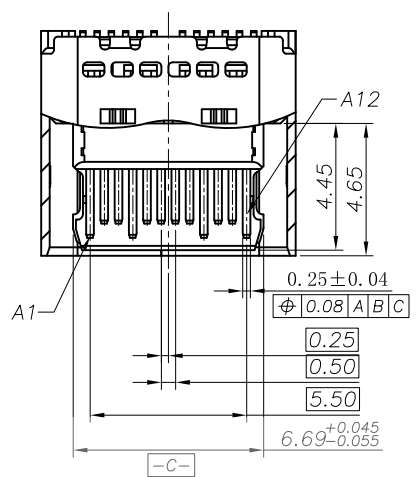
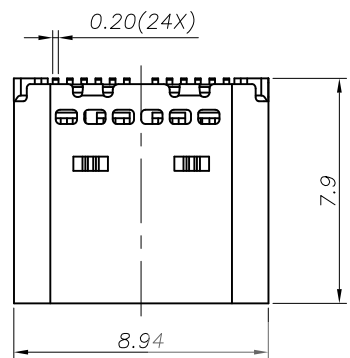
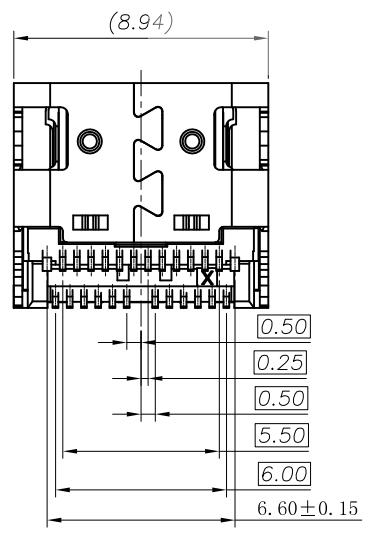
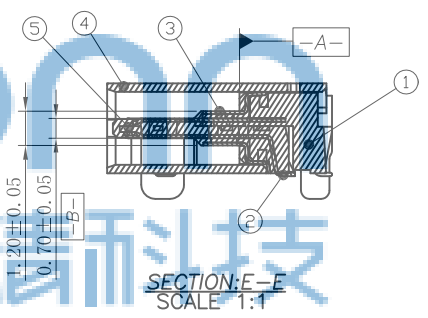
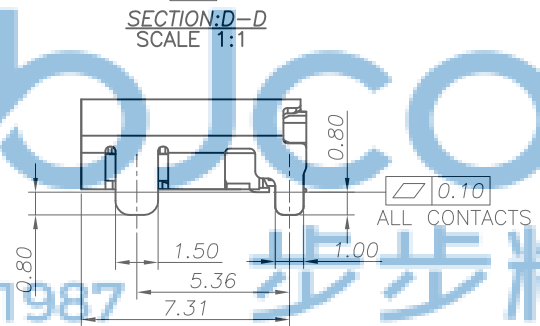
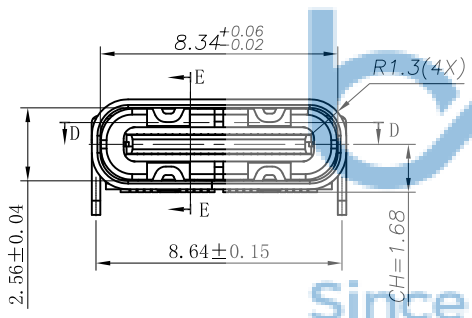

TOLERANCE UNSPECIFIED		深圳市步步精科技有限公司 TITLE: TYPE-C 24P 母座 L=7.90 CH=1.68 板上四脚插 端子双排SMT 莫仕款 缺P	
.0	±0.35	DRAWN/ DATE	设计 TSP
.00	±0.25	CHECKED/ DATE	审核 LYX
.000	±0.15	APPROVED/ DATE	核准 LJP
X. °	±2.00°	SIZE: A4	UNIT: MM.
CUSTOMER DRAWING		PART. NO: UC.01.22-12-0001	PROJECTION
		DWG. PATH	REV.: 版本
		0049-1	SHEET: 页码



REV.	DESCRIPTION	NAME	DATE
A	NEWS ISSUE		

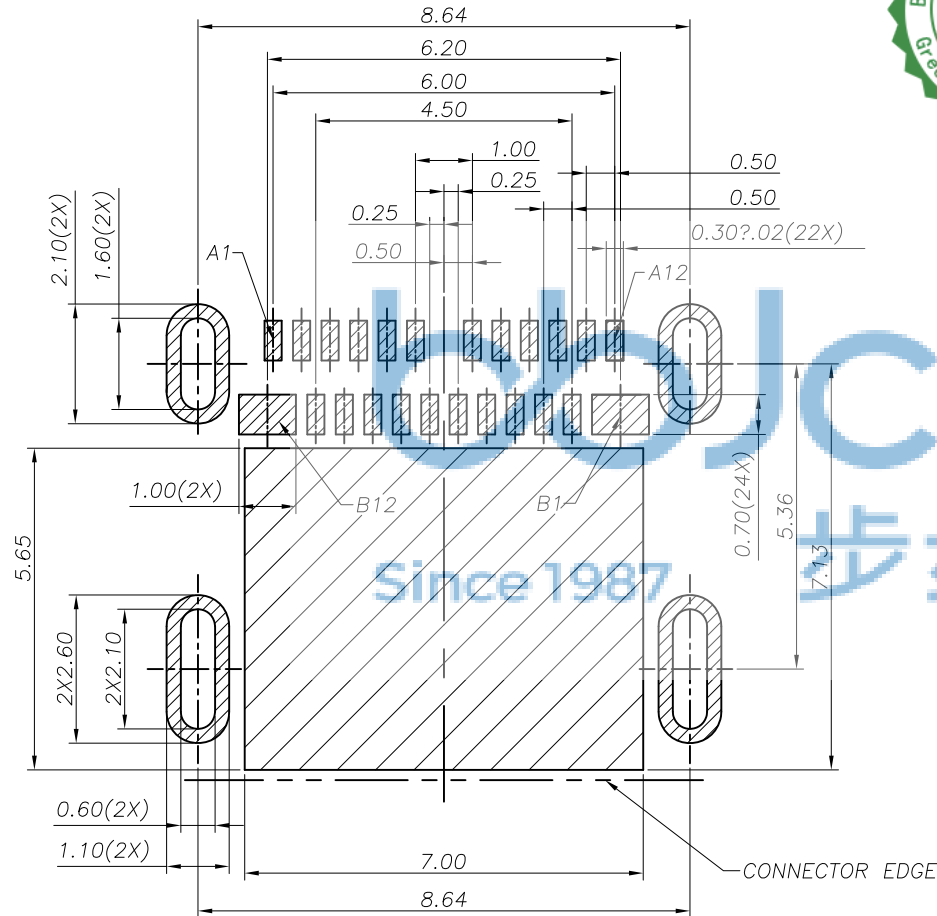

RECOMMENDED PCB LAYOUT(TOP VIEW)  
THICKNESS 0.60MM;DEFAULT TOLERANCE:±0.05

USB TYPE-C PIN ASSIGNMENTS

PIN NUMBER	SIGNAL NAME	PIN NUMBER	SIGNAL NAME
A1	GND	B12	GND
A2	TXp1	B11	RXp1
A3	TXn1	B10	RXn1
A4	Vbus	B9	Vbus
A5	CC1	B8	SBU2
A6	Dp1	B7	Dn2
A7	Dn1	B6	Dp2
A8	SBU1	B5	CC2
A9	Vbus	B4	Vbus
A10	RXn2	B3	TXn2
A11	RXp2	B2	TXp2
A12	GND	B1	GND

TOLERANCE UNSPECIFIED

.0	±0.35
.00	±0.25
.000	±0.15
X.°	±2.00°

CUSTOMER DRAWING

**深圳市步步精科技有限公司**

TITLE:  
TYPE-C 24P 母座 L=7.90 CH=1.68 板上四脚插 端子双排SMT 莫仕款 缺P

DRAWN/ DATE	设计 TSP	SIZE:A4	UNIT:MM.	PART. NO: UC.01.22-12-0001
CHECKED/ DATE	审核 LYX	SCALE: 1:1	PROJECTION	REV.: 版本
APPROVED/ DATE	核准 LJP	DWG. PATH	0049-1	SHEET: 页码

REV.	DESCRIPTION	NAME	DATE
A	NEWS ISSUE		

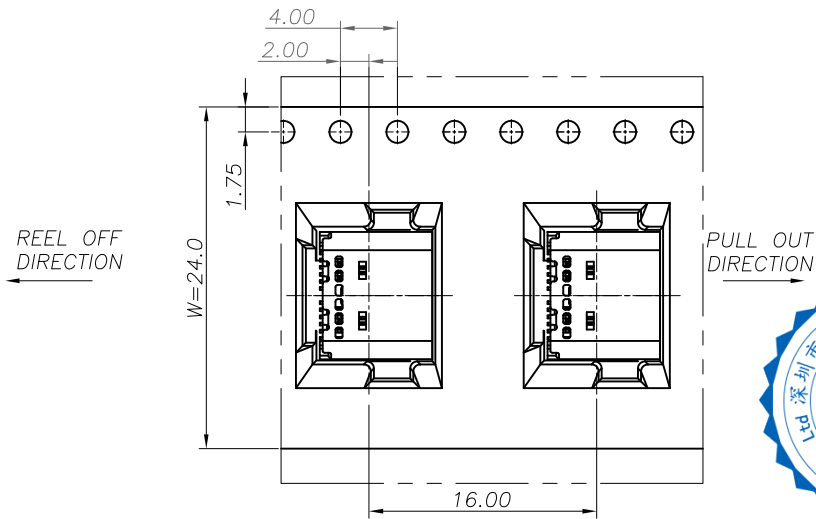
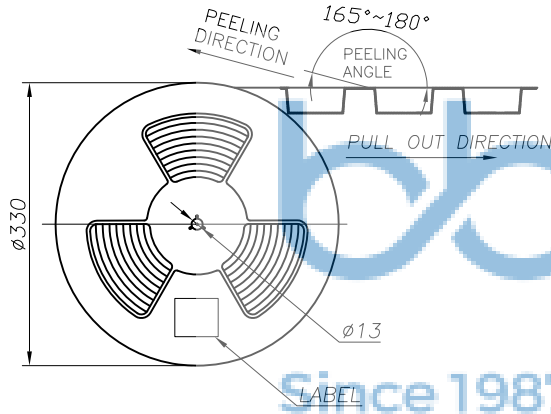
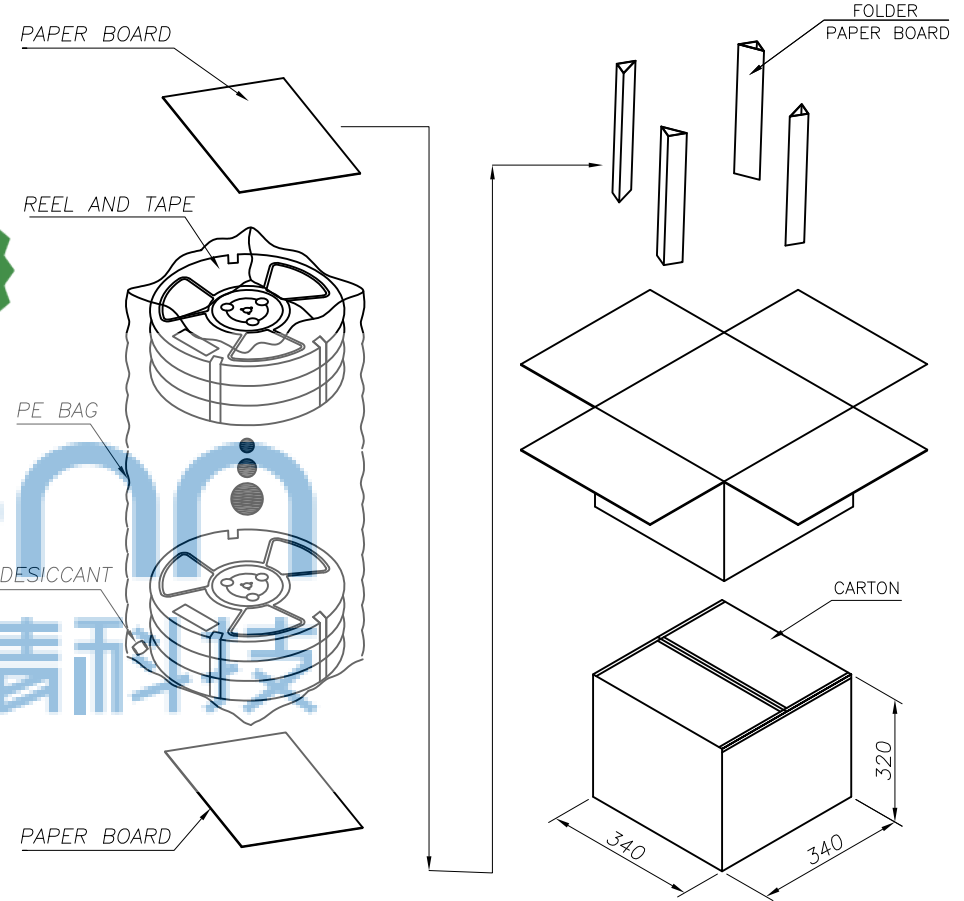
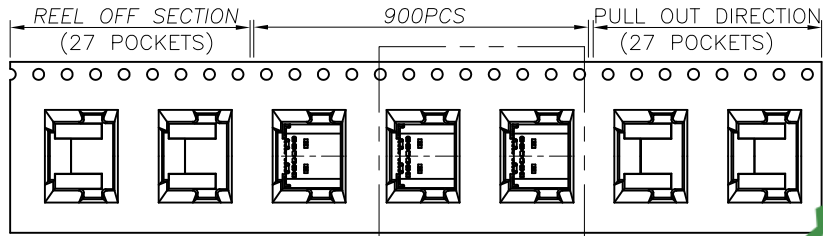

TOLERANCE UNSPECIFIED		深圳市步步精科技有限公司 TITLE: TYPE-C 24P 母座 L=7.90 CH=1.68 板上四脚插 端子双排SMT 莫仕款 缺P	
.0	±0.35	SIZE:A4	UNIT:MM.
.00	±0.25	PART. NO:UC.01.22-12-0001	
.000	±0.15	SCALE: 1:1	PROJECTION
X.°	±2.00°	DWG. PATH	REV.: 版本
CUSTOMER DRAWING		0049-1	SHEET: 页码
DRAWN/ DATE	设计 TSP		
CHECKED/ DATE	审核 LYX		
APPROVED/ DATE	核准 LJP		