

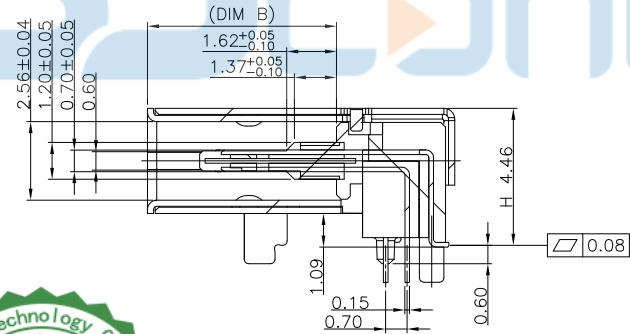

| REV. | DESCRIPTION | NAME | DATE |
|------|-------------|------|------|
| A | NEWS ISSUE | | |

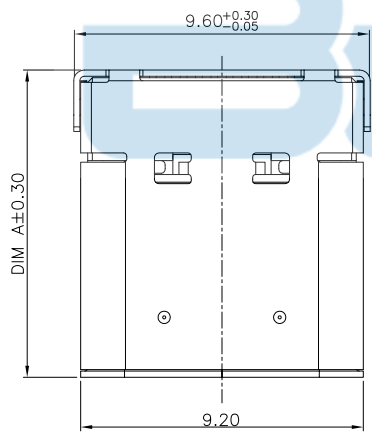

Section A-A
Scale 1:1

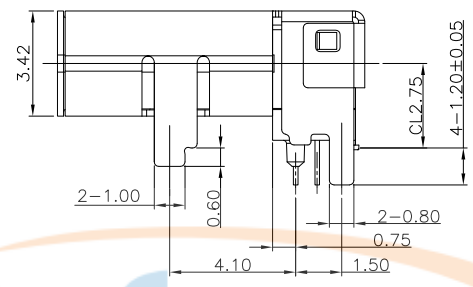
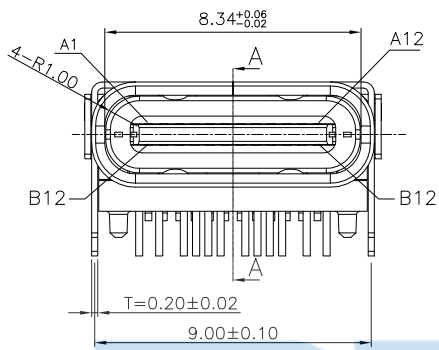

- MATERIAL:
 - MOLDING: LCP UL94 V-0
 - CONTACT: COPPER ALLOY.
 - PLATED GOLD ON CONTACT AREA, G/F, GOLD ON SOLDER AREA, 50u" NICKEL PLATING OVER ALL.
 - SHELL: SUS304-H,T=0.30±0.03mm
 - 50u" NICKEL PLATING OVER ALL.
 - EMI SHILD: SUS304-H,T=0.12±0.03mm
 - LATCH: SUS301-H,T=0.15±0.03mm
- MECHANICAL:
 - INSERTION: 5~20N.
 - EXTRACTION: 8~20N.
 - DURABILITY: 10000 CYCLES
- ELECTRICAL:
 - CURRENT: 5A MAX FOR VBUS; 1.25A FOR GND, 0.25A FOR OTHER OTHER.
 - VOLTAGE: 20VDC MAX
 - WITHSTANDING VOLTAGE: 100V AC.
 - CONTACT RESISTANCE: 40mΩ MAX.
 - INSULATION RESISTANCE: 100MΩ MIN.
- ENVIRONMENTAL
 - TEMPERATURE RANGE: -30°C TO +80°C

| NO | DIM A | DIM B |
|----|-------|-------|
| 3 | 10.0 | 6.2 |
| 4 | 8.65 | 4.85 |
| | -- | -- |

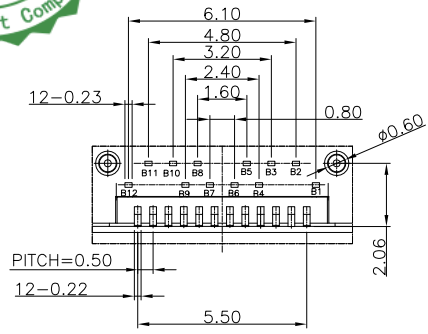
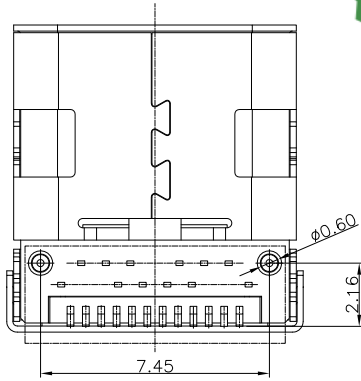

Detail A
Scale 1:1

| | |
|--------------------|--------|
| GENERAL TOLERANCE: | |
| 0. | ±0.38 |
| 0.0 | ±0.25 |
| 0.00 | ±0.15 |
| 0.0° | ±2° |
| DRAWN/ DATE | 设计 LYX |
| CHECKED/ DATE | 审核 HMY |
| APPROVED/ DATE | 核准 LJP |

深圳市步步精科技有限公司

TITLE:
TYPE-C 24P 母座 板上 双壳 四脚插 垫高1.09 L=10.0 CH2.75 DIP+SMT

| | | | |
|------------|------------|---------------------------|-----------|
| SIZE:A4 | UNIT:MM. | PART.NO: UC.01.12-1W-0001 | REV.: 版本 |
| SCALE: 1:1 | PROJECTION | 0228-1 | SHEET: 页码 |



出料方向
PULL OUT DIRECTEON

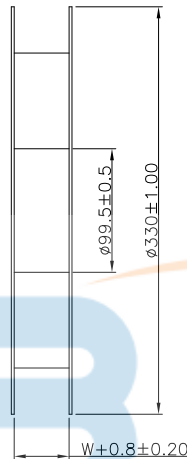
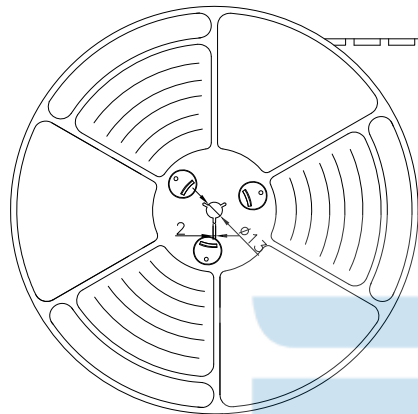

NOTES

- 帶子引導長度
LEAD TAPE LENGTH
出料方向
PULL OUT DIRECTEON

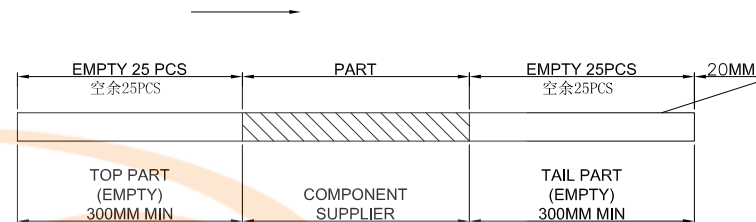

- 出貨運輸過程中一定注意：
THIS REQUIREMENT SHOULD BE APPLIED AT SHIPMENT：
卷帶在運輸過程中不能散開
PEELING OFF SHOULD NOT BE ALLOWED DURING TRANSPORTATION

出料方向

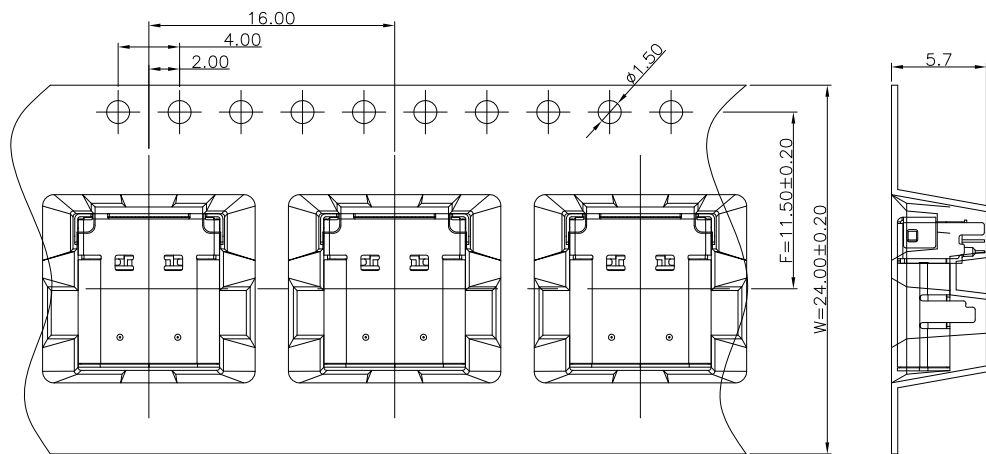

| | | | | | |
|--------------------|--|--|--------|------------|-------------------------------------|
| GENERAL TOLERANCE: | | 深圳市步步精科技有限公司 | | | |
| 0. ±0.38 | | TITLE: | | | |
| 0.0 ±0.25 | | TYPE-C 24P 母座 板上 双壳 四脚插 垫高1.09 L=10.0 CH2.75 DIP+SMT | | | |
| 0.00 ±0.15 | | DRAWN/ DATE | 设计 LYX | SIZE:A4 | UNIT:MM. PART. NO: UC.01.12-1W-0001 |
| 0.0° ±2° | | CHECKED/ DATE | 审核 HMY | SCALE: 1:1 | PROJECTION |
| | | APPROVED/ DATE | 核准 LJP | DWG. PATH | 0228-1 |
| | | | | | REV.: 版本 |
| | | | | | SHEET: 页码 |

| REV. | DESCRIPTION | NAME | DATE |
|------|-------------|------|------|
| A | NEWS ISSUE | | |



| REV. | DESCRIPTION | NAME | DATE |
|------|-------------|------|------|
| A | NEWS ISSUE | | |

at small positioning hole of the carrier tape side).
 標籤黏貼處 (朝捲裝包材的小定位孔一側)

Location of label sticking (label

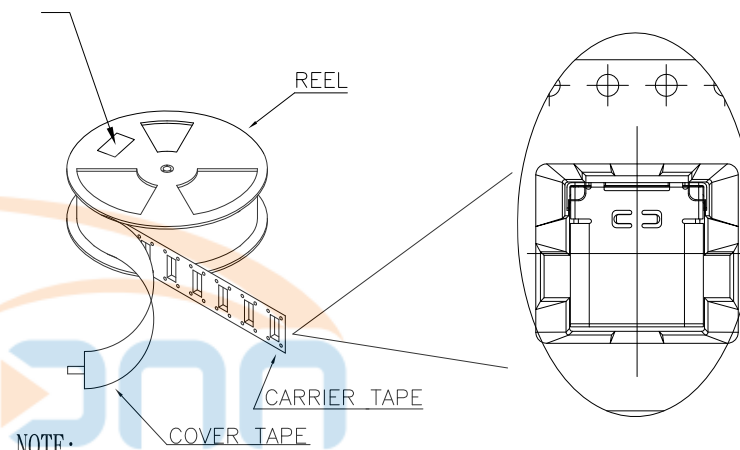
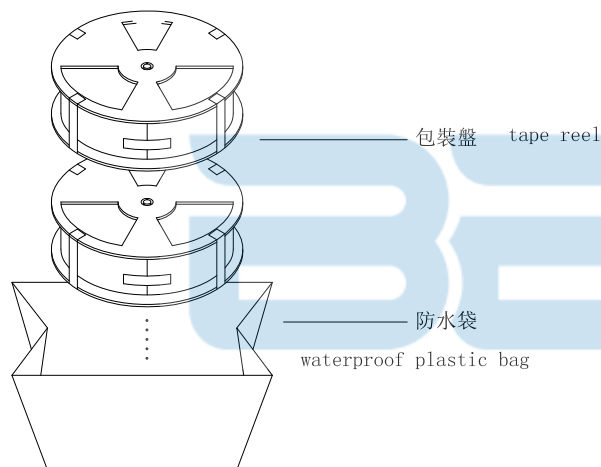

1. 每捲包裝數量及每箱裝箱數量如左下表格。
Packing q'ty of each reel & carton as below table shown.
2. 以上膠帶覆蓋下包裝帶經包裝機熱熔包裝
Use cover tape to cover and hot melt machine to seal up.
3. 將裝滿產品的卷盤放入紙箱并以膠帶封口
Put reels in the carton and use adhesive tape to seal up.

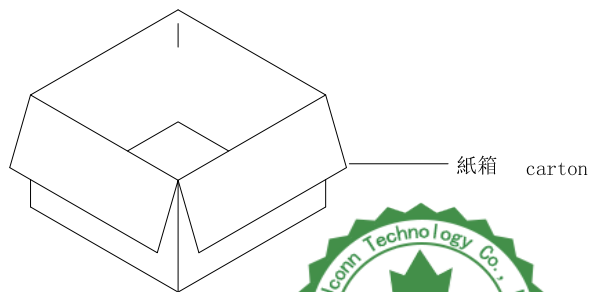

| 包裝容量 (PACKING CAPACITY) | | | 重量 WEIGHT (Kg) | | |
|-------------------------|--------------|------------|----------------|----------|----------|
| PCS/REEL | REELS/CARTON | PCS/CARTON | N.W./PCS | N.W./BOX | G.W./BOX |
| 700 | 10 | 7000 | 0.704 | | |

| | | | | | |
|--------------------|--------|--|----------|----------------------------|-----------|
| GENERAL TOLERANCE: | | 深圳市步步精科技有限公司 TITLE: TYPE-C 24P 母座 板上 双壳 四脚插 垫高1.09 L=10.0 CH2.75 DIP+SMT | | | |
| DRAWN/ DATE | 设计 LYX | SIZE:A4 | UNIT:MM. | PART. NO: UC.01.12-1W-0001 | |
| CHECKED/ DATE | 审核 HMY | SCALE: 1:1 | | PROJECTION | REV.: 版本 |
| APPROVED/ DATE | 核准 LJP | DWG. PATH | 0228-1 | | SHEET: 页码 |